

# SALES CATALOG

C A B I N E T S



## 5 YEAR LIMITED WARRANTY

Vendor warrants to the original consumer purchaser that cabinetry, door hinges, and drawer glides will be free from defects in material and workmanship under normal use and service for a period of Five (5) years from purchase date (Proof of Purchase is required). This warranty is not transferable and only applicable to product used for residential purposes. Representatives of this cabinet line do not have the authority to change or enlarge this warranty.

This warranty does not cover normal wear and tear, damage or defects caused by accidents, misuse, abuse, or lack of necessary maintenance; nor does it cover alteration, modification, improper installation, improper handling / storage, environmental conditions, nor any labor expenses.

Vendor, at our option, may elect to repair or replace with a functionally equivalent product any product covered by this warranty. Some replacement parts are subject to availability and may differ from original parts received. Return of defective product may be required for a replacement to be issued. Repair parts or replacement parts are at the expense of the vendor, but customer shall bear all other expenses. These expenses may include, but are not limited to, cost of removal and re-installation of product, labor expenses, etc.

Just as no two trees are alike, no two pieces of wood are alike. The variation in color and grain pattern in wood adds to its natural beauty and is not considered an imperfection. Environmental factors, including but not limited to artificial / natural light, moisture, cleaners, smoke, etc, may cause the darkening or mellowing of a cabinet over time. This is a natural process and can be expected. This warranty does not cover the natural aging or darkening / mellowing of wood color, the inherent growth characteristics of, or variation in wood.



Some of the cabinet lines feature a glazed finish that accentuates the door and drawer front profiles. This glaze is hand-applied over a stain or paint and may, due to the nature of application, consist of random drips, runs, etc. As glazing is a hand-applied process there will be variations in color and appearance from door to door and cabinet to cabinet. This is not considered a defect and is considered normal with hand applied finishes.

It is the nature of wood to expand and contract to varying degrees depending on climate conditions. As a result, cabinet lines with painted surfaces may show fractures in the paint at joints. This is normal and is not considered a defect.

This warranty is valid only in the United States of America and is not transferable. All implied warranties are limited in duration to the shorter of the period provided by law or the period of this warranty. To the extent permitted by law, this warranty excludes special, incidental, or consequential damages. Some states do not allow the exclusion or limitations of incidental or consequential damages or limitations on how long an implied warranty lasts, so the above limitations or exclusions may not apply to you. This warranty gives you specific legal rights; you may have other rights which vary from state to state.

To exercise this warranty, please contact the supplier from whom you purchased the product. Report, in writing, all defects claimed and include proof of purchase documentation.

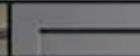
# SPECIAL FEATURES

										
FEATURES	ASP	HS	NG	PS	WPG	WS	MBS	FS	CS	RH
SOLID HARDWOOD FACE FRAMES	◆	◆	◆	◆	◆	◆	◆	◆	◆	◆
3/4" PLYWOOD SHELVES	◆	◆	◆	◆	◆	◆	◆	◆	◆	◆
NO PARTICLE BOARD	◆	◆	◆	◆	◆	◆	◆	◆	◆	◆
BUTT-STYLE DOORS	◆	◆	◆	◆	◆	◆	◆	◆	◆	◆
STAINLESS STEEL BASKETS	◆	◆	◆	◆	◆	◆	◆	◆	◆	◆
1/2" PLYWOOD CONSTRUCTION	◆	◆	◆	◆	◆	◆	◆	◆	◆	◆
CABINET BOX & SHELVES STAIN MATCHED	◆			◆	◆	◆		◆	◆	
NATURAL WOOD BOX & SHELVES		◆								◆
ENGINEERED HDF/VENEER CENTER DOOR PANEL	◆			◆		◆	◆	◆		
RAISED PANEL DOORS	◆									
FLAT PANEL / SHAKER STYLE DOORS		◆	◆	◆	◆	◆	◆	◆	◆	◆
SOFT CLOSE ADJUSTABLE CONCEALED HINGES	◆	◆	◆	◆	◆	◆	◆	◆	◆	◆
3/4" SOLID WOOD DOVETAIL DRAWERS	◆	◆	◆	◆	◆	◆	◆	◆	◆	◆
FULL EXTENSION GLIDES	◆	◆	◆	◆	◆	◆	◆	◆	◆	◆
UNDERMOUNT SOFT CLOSE DRAWER GLIDES	◆	◆	◆	◆	◆	◆	◆	◆	◆	◆
FULL OVERLAY	◆	◆	◆	◆	◆	◆	◆	◆	◆	◆
PARTIAL OVERLAY										
NATURAL WOOD DRAWER BOXES & ROTS	◆	◆	◆	◆	◆	◆	◆	◆	◆	◆

## COLOR KEY

Aspen White	= ASP	Winchester Grey	= NG	Hickory Shaker	= HS
West Point Grey	= WPG	White Shaker	= WS	Platinum Shaker	= PS
Fresh Sage	= FS	Carmel Shaker	= CS	Midnight Black Shaker	= MBS
Rustic Hickory	= RH				

# PREMIUM QUALITY CABINETS

## Standard Special Features At No Cost To You

- Solid hardwood door frames and face frames with hardwood or engineered center panels.
- White Shaker, Aspen White, Platinum Shaker, Midnight Black Shaker and Fresh Sage are composed of solid HDF to ensure the highest quality painted shaker style doors.
- Cabinet boxes are ½” plywood construction including sides, tops, and bottoms for lasting durability and strength.
- Most cabinet boxes are match stained and finished inside and out.
- ¾” Plywood shelves are standard in all cabinets.
- Soft Close full extension under mount drawer glides are standard on all lines.
- Soft close door hinges are standard on cabinets.
- Aspen White, West Point Grey, Winchester Grey, White Shaker, Platinum Shaker, Hickory Shaker, Midnight Black Shaker, Fresh Sage, and Carmel Shaker are full overlay cabinet lines.
- Butt-style doors eliminate the center stile between the doors and allow for easier use of the cabinet.
- Stainless steel baskets are standard in all lazy Susan cabinets.
- ¾” Hardwood Dovetail Drawer Boxes standard on all cabinets.



### **Huge Stock**

Our fully-stocked 750,000 Square foot warehouse means Faster fulfillment on most orders.



# TABLE OF CONTENT

• Cabinet Styles .....	1-3
• Wall Cabinets .....	4-10
• Base Cabinets.....	11-16
• Pantry / Utility Cabinets.....	17-19
• Vanity Cabinets.....	20-22
• ADA Cabinets.....	23-25
• Accessories.....	26-32
• Panels, Fillers & Trims.....	33-40
• Sample Doors .....	41
• Kitchen Images.....	42

# CABINET STYLES



# CABINET STYLES



**HICKORY SHAKER (HS)**



**WINCHESTER GREY (NG)**



**MIDNIGHT BLACK SHAKER (MBS)**

# CABINET STYLES

**WEST POINT GREY (WPG)**



**WHITE SHAKER (WS)**



**PLATINUM SHAKER (PS)**



**RUSTIC HICKORY (RH)**



# WALL

C A B I N E T S



# SINGLE DOOR WALL CABINETS



## SPECIFICATIONS:

- 30" AND 36" TALL CABINETS HAVE TWO ADJUSTABLE SHELVES
- 42" TALL CABINETS HAVE THREE ADJUSTABLE SHELVES
- DOORS MAY BE REPLACED WITH CORRESPONDING GLASS DOOR (SEE PAGE 31-32).

ITEM	SIZES	ASP	HS	NG	PS	WPG	WS	MBS	FS	CS	RH
W0930	9 x 30 x 12	\$207.19	\$223.19	\$223.19	\$185.93	\$223.19	\$185.93	\$195.23	\$195.23	\$198.95	\$223.19
W0936	9 x 36 x 12	\$224.17	\$253.30	\$253.30	\$201.22	\$253.30	\$201.22	\$211.28	\$211.28	\$215.31	\$253.30
W0942	9 x 42 x 12	\$257.46	\$278.04	\$278.04	\$245.20	\$278.04	\$245.20	\$257.46	\$257.46	\$262.36	\$278.04
W1230	12 x 30 x 12	\$215.86	\$260.86	\$260.86	\$193.37	\$260.86	\$193.37	\$203.04	\$203.04	\$206.91	\$260.86
W1236	12 x 36 x 12	\$241.82	\$304.42	\$304.42	\$221.80	\$304.42	\$221.80	\$232.89	\$232.89	\$237.33	\$304.42
W1242	12 x 42 x 12	\$286.51	\$330.62	\$330.62	\$272.87	\$330.62	\$272.87	\$286.51	\$286.51	\$291.97	\$330.62
W1530	15 x 30 x 12	\$239.27	\$298.91	\$298.91	\$218.40	\$298.91	\$218.40	\$229.32	\$229.32	\$233.96	\$298.91
W1536	15 x 36 x 12	\$268.30	\$353.60	\$353.60	\$246.46	\$353.60	\$246.46	\$258.78	\$258.78	\$263.71	\$353.60
W1542	15 x 42 x 12	\$312.81	\$381.11	\$381.11	\$297.91	\$381.11	\$297.91	\$312.81	\$312.81	\$318.76	\$381.11
W1830	18 x 30 x 12	\$290.04	\$345.83	\$345.83	\$276.23	\$345.83	\$276.23	\$290.04	\$290.04	\$295.57	\$345.83
W1836	18 x 36 x 12	\$335.91	\$402.82	\$402.82	\$345.83	\$402.82	\$345.83	\$363.12	\$363.12	\$370.04	\$402.82
W1842	18 x 42 x 12	\$374.37	\$434.83	\$434.83	\$343.35	\$434.83	\$343.35	\$360.52	\$360.52	\$367.38	\$434.83
W2130	21 x 30 x 12	\$322.22	\$389.38	\$389.38	\$285.01	\$389.38	\$285.01	\$299.26	\$299.26	\$304.96	\$389.38
W2136	21 x 36 x 12	\$355.87	\$444.49	\$444.49	\$317.23	\$444.49	\$317.23	\$333.09	\$333.09	\$339.44	\$444.49
W2142	21 x 42 x 12	\$425.17	\$489.68	\$489.68	\$404.92	\$489.68	\$404.92	\$425.17	\$425.17	\$433.26	\$489.68

# DOUBLE DOOR WALL CABINETS



## SPECIFICATIONS:

- 30" AND 36" TALL CABINETS HAVE TWO ADJUSTABLE SHELVES.
- 42" TALL CABINETS HAVE THREE ADJUSTABLE SHELVES.
- BUTT DOORS ON CABINETS ARE 24" THOUGH 36" WIDE.
- DOORS MAY BE REPLACED WITH CORRESPONDING GLASS DOOR (SEE PAGE 31-32).

ITEM	SIZES	ASP	HS	NG	PS	WPG	WS	MBS	FS	CS	RH
W2430	24 x 30 x 12	\$357.23	\$440.50	\$440.50	\$311.35	\$440.50	\$311.35	\$326.92	\$326.92	\$333.14	\$440.50
W2436	24 x 36 x 12	\$386.84	\$500.98	\$500.98	\$351.67	\$500.98	\$351.67	\$369.25	\$369.25	\$376.29	\$500.98
W2442	24 x 42 x 12	\$460.70	\$550.70	\$550.70	\$422.73	\$550.70	\$422.73	\$443.87	\$443.87	\$452.32	\$550.70
W2730	27 x 30 x 12	\$395.75	\$476.49	\$476.49	\$344.78	\$476.49	\$344.78	\$362.02	\$362.02	\$368.91	\$476.49
W2736	27 x 36 x 12	\$415.22	\$543.02	\$543.02	\$368.68	\$543.02	\$368.68	\$387.11	\$387.11	\$394.49	\$543.02
W2742	27 x 42 x 12	\$474.08	\$766.08	\$766.08	\$430.54	\$766.08	\$430.54	\$452.07	\$452.07	\$460.68	\$766.08
W3030	30 x 30 x 12	\$389.70	\$517.94	\$517.94	\$355.40	\$517.94	\$355.40	\$373.17	\$373.17	\$380.28	\$517.94
W3036	30 x 36 x 12	\$446.03	\$571.16	\$571.16	\$408.87	\$571.16	\$408.87	\$429.31	\$429.31	\$437.49	\$571.16
W3042	30 x 42 x 12	\$504.22	\$838.91	\$838.91	\$468.72	\$838.91	\$468.72	\$492.16	\$492.16	\$501.53	\$838.91
W3330	33 x 30 x 12	\$411.84	\$565.28	\$565.28	\$377.66	\$565.28	\$377.66	\$396.54	\$396.54	\$404.10	\$565.28
W3336	33 x 36 x 12	\$470.81	\$607.53	\$607.53	\$435.37	\$607.53	\$435.37	\$457.14	\$457.14	\$465.85	\$607.53
W3342	33 x 42 x 12	\$548.03	\$906.82	\$906.82	\$508.28	\$906.82	\$508.28	\$533.69	\$533.69	\$543.86	\$906.82
W3630	36 x 30 x 12	\$439.37	\$614.67	\$614.67	\$410.51	\$614.67	\$410.51	\$431.04	\$431.04	\$439.25	\$614.67
W3636	36 x 36 x 12	\$501.21	\$658.22	\$658.22	\$461.58	\$658.22	\$461.58	\$484.66	\$484.66	\$493.89	\$658.22
W3642	36 x 42 x 12	\$577.35	\$976.21	\$976.21	\$534.49	\$976.21	\$534.49	\$561.21	\$561.21	\$571.90	\$976.21
W3930	39 x 30 x 12	\$486.30	\$658.39	\$658.39	\$439.82	\$658.39	\$439.82	\$461.81	\$461.81	\$470.61	\$658.39
W3936	39 x 36 x 12	\$538.55	\$709.34	\$709.34	\$490.69	\$709.34	\$490.69	\$515.12	\$515.12	\$525.04	\$709.34
W3942	39 x 42 x 12	\$588.91	\$1,044.92	\$1,044.92	\$560.87	\$1,044.92	\$560.87	\$588.91	\$588.91	\$600.13	\$1,044.92
W4230	42 x 30 x 12	\$514.68	\$680.86	\$680.86	\$468.72	\$680.86	\$468.72	\$492.16	\$492.16	\$501.53	\$680.86
W4236	42 x 36 x 12	\$565.88	\$764.40	\$764.40	\$525.21	\$764.40	\$525.21	\$551.47	\$551.47	\$561.97	\$764.40
W4242	42 x 42 x 12	\$643.92	\$1,063.52	\$1,063.52	\$586.87	\$1,063.52	\$586.87	\$616.21	\$616.21	\$627.95	\$1,063.52

# BRIDGE WALL CABINETS

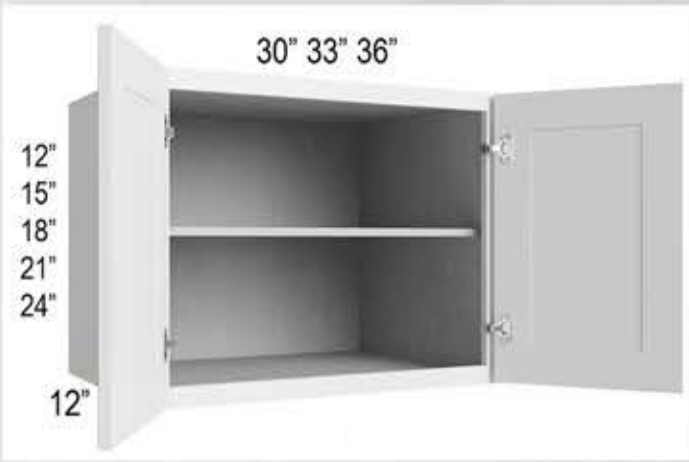

## SPECIFICATIONS:

- 24" TALL CABINETS HAVE ONE ADJUSTABLE SHELF.
- THE REMAINING HEIGHTS HAVE NO SHELVES.
- BUTT DOORS ON CABINETS ARE 24" THROUGH 36" WIDE.

ITEM	SIZES	ASP	HS	NG	PS	WPG	WS	MBS	FS	CS	RH
W3012	30 x 12 x 12	\$252.68	\$303.58	\$303.58	\$221.63	\$303.58	\$221.63	\$232.71	\$232.71	\$237.14	\$303.58
W3312	33 x 12 x 12	\$261.18	\$338.31	\$338.31	\$245.87	\$338.31	\$245.87	\$258.16	\$258.16	\$263.08	\$338.31
W3612	36 x 12 x 12	\$295.09	\$354.44	\$354.44	\$263.55	\$354.44	\$263.55	\$276.73	\$276.73	\$282.00	\$354.44
W3015	30 x 15 x 12	\$257.52	\$365.44	\$365.44	\$235.24	\$365.44	\$235.24	\$274.00	\$274.00	\$251.71	\$365.44
W3315	33 x 15 x 12	\$278.43	\$395.43	\$395.43	\$248.85	\$395.43	\$248.85	\$261.29	\$261.29	\$266.27	\$395.43
W3615	36 x 15 x 12	\$294.79	\$423.74	\$423.74	\$266.03	\$423.74	\$266.03	\$279.33	\$279.33	\$284.65	\$423.74
W3018	30 x 18 x 12	\$268.67	\$406.27	\$406.27	\$242.63	\$406.27	\$242.63	\$254.76	\$254.76	\$259.61	\$406.27
W3318	33 x 18 x 12	\$307.35	\$441.29	\$441.29	\$276.86	\$441.29	\$276.86	\$290.07	\$290.07	\$296.24	\$441.29
W3618	36 x 18 x 12	\$331.13	\$463.09	\$463.09	\$290.01	\$463.09	\$290.01	\$304.51	\$304.51	\$310.31	\$463.09
W3021	30 x 21 x 12	\$324.92	\$449.53	\$449.53	\$307.06	\$449.53	\$307.06	\$322.41	\$322.41	\$328.55	\$449.53
W3321	33 x 21 x 12	\$354.04	\$486.65	\$486.65	\$337.18	\$486.65	\$337.18	\$354.04	\$354.04	\$360.71	\$486.65
W3621	36 x 21 x 12	\$420.36	\$498.04	\$498.04	\$400.34	\$498.04	\$400.34	\$420.36	\$420.36	\$428.36	\$498.04
W3024	30 x 24 x 12	\$354.46	\$478.17	\$478.17	\$328.61	\$478.17	\$328.61	\$345.04	\$345.04	\$351.61	\$478.17
W3324	33 x 24 x 12	\$385.57	\$504.67	\$504.67	\$367.21	\$504.67	\$367.21	\$385.57	\$385.57	\$392.91	\$504.67
W3624	36 x 24 x 12	\$442.85	\$529.07	\$529.07	\$421.76	\$529.07	\$421.76	\$442.85	\$442.85	\$451.28	\$529.07





## DIAGONAL CORNER WALL CABINETS

### SPECIFICATIONS:

- 30" AND 36" TALL CABINETS HAVE TWO ADJUSTABLE SHELVES.
- 42" TALL CABINETS HAVE THREE ADJUSTABLE SHELVES.
- DOOR MAY BE REPLACED WITH CORRESPONDING DIAGONAL GLASS DOOR. (SEE PAGE 31-32).

ITEM	SIZES	ASP	HS	NG	PS	WPG	WS	MBS	FS	CS	RH
WDC2430	24 x 30 x 12	\$513.37	\$542.14	\$542.14	\$488.92	\$542.14	\$488.92	\$513.37	\$513.37	\$523.14	\$542.14
WDC2436	24 x 36 x 12	\$603.07	\$583.21	\$583.21	\$574.35	\$583.21	\$574.35	\$603.07	\$603.07	\$614.55	\$583.21
WDC2442	24 x 42 x 12	\$702.82	\$682.12	\$682.12	\$669.35	\$682.12	\$669.35	\$702.82	\$702.82	\$716.20	\$682.12
ITEM	SIZES	ASP	HS	NG	PS	WPG	WS	MBS	FS	CS	RH
WDC42PG	24 x 42 x 12	\$1,071.55	\$1,020.52	\$1,020.52	\$1,020.52	\$1,020.52	\$1,020.52	\$1,071.55	\$1,071.55	\$1,091.96	\$542.14
WDC2442PG	24 x 42 x 12	N/A	N/A	N/A	N/A	N/A	\$1,020.52	N/A	\$1,071.55	\$1,091.96	\$583.21



## BLIND CORNER WALL CABINETS

### SPECIFICATIONS:

- 30" AND 36" TALL CABINETS HAVE TWO ADJUSTABLE SHELVES.
- 42" TALL CABINETS HAVE THREE ADJUSTABLE SHELVES.

ITEM	SIZES	ASP	HS	NG	PS	WPG	WS	MBS	FS	CS	RH
WBC2730	27 x 30 x 12	\$452.60	\$499.04	\$499.04	\$431.05	\$499.04	\$431.05	\$452.60	\$452.60	\$461.22	\$499.04
WBC2736	27 x 36 x 12	\$526.51	\$572.80	\$572.80	\$501.44	\$572.80	\$501.44	\$526.51	\$526.51	\$536.54	\$572.80
WBC2742	27 x 42 x 12	\$611.18	\$635.63	\$635.63	\$582.08	\$635.63	\$582.08	\$611.18	\$611.18	\$622.83	\$635.63



## ANGLED END WALL CABINETS

### SPECIFICATIONS:

- 30" AND 36" TALL CABINETS HAVE TWO ADJUSTABLE SHELVES.
- 42" TALL CABINETS HAVE THREE ADJUSTABLE SHELVES.

ITEM	SIZES	ASP	HS	NG	PS	WPG	WS	MBS	FS	CS	RH
WCA1230	12 x 30 x 12	\$250.35	\$282.11	\$282.11	\$238.43	\$282.11	\$238.43	\$250.35	\$250.35	\$255.12	\$282.11
WCA1236	12 x 36 x 12	\$283.26	\$322.14	\$322.14	\$269.77	\$322.14	\$269.77	\$283.26	\$283.26	\$288.65	\$322.14
WCA1242	12 x 42 x 12	\$317.34	\$363.93	\$363.93	\$302.23	\$363.93	\$302.23	\$317.34	\$317.34	\$323.39	\$363.93



## EASY REACH WALL CABINETS

### SPECIFICATIONS:

- 3 TWO TO THREE 1/2 DEPTH ADJUSTABLE (NON-REMOVABLE) SHELVES.
- DECORATIVE HARDWARE SCREWS MUST BE COUNTERSUNK TO PREVENT SCRATCHING OF ADJACENT CABINET

ITEM	SIZES	ASP	HS	NG	PS	WPG	WS	MBS	FS	CS	RH
WER2430	24 x 30 x 12	N/A	\$785.94	\$785.94	\$542.03	\$785.94	\$542.03	\$569.13	\$569.13	\$579.97	\$785.94
WER2436	24 x 36 x 12	N/A	\$773.97	\$773.97	\$533.78	\$773.97	\$533.78	\$560.47	\$560.47	\$571.14	\$773.97
WER2442	24 x 42 x 12	N/A	\$960.81	\$960.81	\$662.63	\$960.81	\$662.63	\$695.76	\$695.76	\$709.01	\$960.81

## SPICE DRAWER WALL CABINET



### SPECIFICATIONS:

- THIS CABINET DOES NOT COME WITH ANY DRAWER SLIDES.
- THE INTERIOR IS FINISHED AND THE CABINET CAN BE USED WITHOUT THE DRAWERS AS A WINE RACK.
- THE DRAWERS CANNOT BE TURNED.
- IF DRAWERS ARE USED THE CABINET MUST BE INSTALLED HORIZONTALLY FOR THEM TO FUNCTION PROPERLY.

ITEM	SIZES	ASP	HS	NG	PS	WPG	WS	MBS	FS	CS	RH
WSC30	6 x 30 x 12	\$233.05	\$212.10	\$219.27	\$221.95	\$219.27	\$221.95	\$233.05	\$233.05	\$237.49	\$212.10

## MICROWAVE WALL CABINETS



### SPECIFICATIONS:

- THIS CABINET IS DESIGNED FOR "COUNTER" STYLE MICROWAVES.
- THERE ARE NO SHELVES IN THIS CABINET.
- OPENING WIDTH IS 26-7/8".
- OPENING HEIGHT IS 18-1/2".
- SHELF DEPTH IS 20".
- CABINET DEPTH IS 18".
- BUTT DOORS ON ALL MICROWAVE CABINETS.

ITEM	SIZES	ASP	HS	NG	PS	WPG	WS	MBS	FS	CS	RH
MW3030	30 x 30 x 18	\$352.00	\$530.92	\$530.92	\$332.30	\$530.92	\$332.30	\$348.92	\$348.92	\$355.56	\$530.92
MW3036	30 x 36 x 18	\$425.17	\$559.40	\$559.40	\$393.79	\$559.40	\$393.79	\$413.48	\$413.48	\$421.36	\$559.40
MW3042	30 x 42 x 18	\$492.45	\$599.63	\$599.63	\$459.44	\$599.63	\$459.44	\$482.41	\$482.41	\$491.60	\$599.63

## THREE DRAWER WALL CABINETS



### SPECIFICATIONS:

- STANDARD HEIGHT DOVETAIL DRAWER

ITEM	SIZES	ASP	HS	NG	PS	WPG	WS	MBS	FS	CS	RH
W3DR18	18 x 18 x 15	N/A	\$630.50	\$662.51	\$630.50	\$662.51	\$630.50	\$662.03	\$662.03	\$674.64	\$530.92
W3DR24	18 x 24 x 15	N/A	\$775.03	\$813.83	\$775.03	\$813.83	\$775.03	\$813.78	\$813.78	\$829.28	\$559.40

## REFRIGERATOR WALL CABINETS

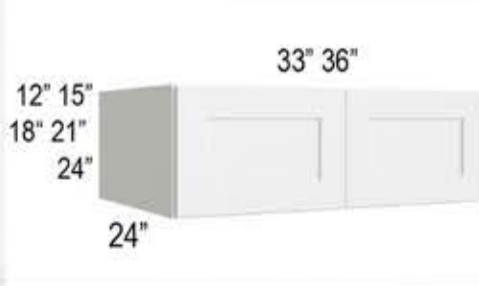

### SPECIFICATIONS:

- 24" TALL CABINETS HAVE ONE ADJUSTABLE SHELF.
- REMAINING HEIGHTS HAVE NO SHELVES.
- 33" WIDE CABINETS ARE AVAILABLE ONLY IN 15" AND 24" HEIGHTS.
- BUTT DOORS ON ALL REFRIGERATOR WALL CABINETS.

ITEM	SIZES	ASP	HS	NG	PS	WPG	WS	MBS	FS	CS	RH
WR3315	33 x 15 x 24	\$335.64	\$440.50	\$440.50	\$319.66	\$440.50	\$319.66	\$335.64	\$335.64	\$342.04	\$440.50
WR3324	33 x 24 x 24	\$411.23	\$459.77	\$459.77	\$391.65	\$459.77	\$391.65	\$411.23	\$411.23	\$419.07	\$459.77
WR3612	36 x 12 x 24	\$376.04	\$353.39	\$353.39	\$358.13	\$353.39	\$358.13	\$376.04	\$376.04	\$383.20	\$353.39
WR3615	36 x 15 x 24	\$403.34	\$476.49	\$476.49	\$384.13	\$476.49	\$384.13	\$403.34	\$403.34	\$411.02	\$476.49
WR3618	36 x 18 x 24	\$436.59	\$508.16	\$508.16	\$415.80	\$508.16	\$415.80	\$436.59	\$436.59	\$444.91	\$508.16
WR3621	36 x 21 x 24	\$469.93	\$521.72	\$521.72	\$447.55	\$521.72	\$447.55	\$469.93	\$469.93	\$478.88	\$521.72
WR3624	36 x 24 x 24	\$436.79	\$572.63	\$572.63	\$415.99	\$572.63	\$415.99	\$436.79	\$436.79	\$445.11	\$572.63

### WALL OVEN CABINET DOUBLE DOOR STACKER

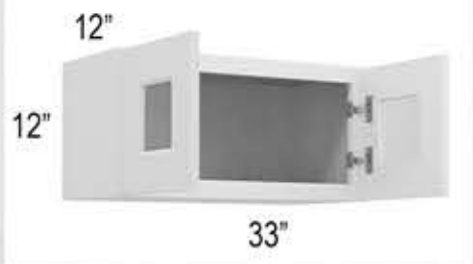

#### SPECIFICATIONS:

- 33" WIDE X 12" HIGH.
- DOORS HAVE PLAIN GLASS FRONTS.
- THESE CABINETS ARE SHIPPED PRE-ASSEMBLED.
- BUTT DOORS ON ALL DOUBLE DOOR STACKER CABINETS.

ITEM	SIZES	ASP	HS	NG	PS	WPG	WS	MBS	FS	CS	RH
DDSWOC3312	33 x 12 x 12	N/A	N/A	N/A	N/A	N/A	\$465.48	\$465.48	\$465.48	\$465.48	N/A

### SINGLE DOOR STACKER WALL DIAGONAL CABINET



#### SPECIFICATIONS:

- 24" WIDE X 12" HIGH.

ITEM	SIZES	ASP	HS	NG	PS	WPG	WS	MBS	FS	CS	RH
SDSWDC2412	24 x 12 x 12	N/A	N/A	N/A	N/A	N/A	\$447.84	\$447.84	\$447.84	\$447.84	N/A

### SINGLE DOOR STACKER WALL CABINETS



#### SPECIFICATIONS:

- DOORS HAVE BEVELED GLASS OR PLAIN GLASS FRONTS.
- THESE CABINETS ARE SHIPPED PRE-ASSEMBLED.
- BUTT DOORS ON ALL DOUBLE DOOR STACKER CABINETS.

ITEM	SIZES	ASP	HS	NG	PS	WPG	WS	MBS	FS	CS	RH
W1212PG	12 x 12 x 12	\$257.90	\$245.62	\$245.62	\$245.62	\$245.62	\$245.62	\$257.90	\$257.90	\$262.81	\$245.62
W1512PG	15 x 12 x 12	\$265.70	\$253.05	\$253.05	\$253.05	\$253.05	\$253.05	\$265.70	\$265.70	\$270.76	\$253.05
W1812PG	18 x 12 x 12	\$279.99	\$266.66	\$266.66	\$266.66	\$266.66	\$266.66	\$279.99	\$279.99	\$285.33	\$266.66
W2112PG	21 x 12 x 12	\$323.21	\$307.82	\$307.82	\$307.82	\$307.82	\$307.82	\$323.21	\$323.21	\$329.37	\$307.82

### DOUBLE DOOR STACKER WALL CABINETS



#### SPECIFICATIONS:

- DOORS HAVE BEVELED GLASS OR PLAIN GLASS FRONTS.
- THESE CABINETS ARE SHIPPED PRE-ASSEMBLED.
- BUTT DOORS ON ALL DOUBLE DOOR STACKER CABINETS.

ITEM	SIZES	ASP	HS	NG	PS	WPG	WS	MBS	FS	CS	RH
W2412PG	24 x 12 x 12	\$345.74	\$329.28	\$329.28	\$329.28	\$329.28	\$329.28	\$345.74	\$345.74	\$352.33	\$329.28
W2712PG	27 x 12 x 12	\$362.28	\$345.03	\$345.03	\$345.03	\$345.03	\$345.08	\$362.33	\$362.33	\$369.24	\$345.03
W3012PG	30 x 12 x 12	\$372.03	\$354.31	\$354.31	\$354.31	\$354.31	\$354.31	\$372.03	\$372.03	\$379.11	\$354.31
W3312PG	33 x 12 x 12	\$387.90	\$369.43	\$369.43	\$369.44	\$369.43	\$369.44	\$387.81	\$387.81	\$395.03	\$369.43
W3612PG	36 x 12 x 12	\$424.42	\$404.21	\$404.21	\$404.21	\$404.21	\$404.21	\$424.42	\$424.42	\$432.50	\$404.21

## 18" HIGH SINGLE DOOR WALL CABINETS

## SPECIFICATIONS:

- NO SHELF.
- 18" TALL.



ITEM	SIZES	ASP	HS	NG	PS	WPG	WS	MBS	FS	CS	RH
W1218	12 x 18 x 12	N/A	\$233.97	\$233.97	\$161.36	\$233.97	\$161.36	\$169.43	\$169.43	\$172.66	\$233.97
W1518	15 x 18 x 12	N/A	\$262.39	\$262.39	\$180.96	\$262.39	\$180.96	\$190.01	\$190.01	\$193.63	\$262.39
W1818	18 x 18 x 12	N/A	\$290.81	\$290.81	\$200.56	\$290.81	\$200.56	\$210.59	\$210.59	\$214.60	\$290.81



**MIDNIGHT BLACK SHAKER**

# BASE

C A B I N E T S



**SINGLE DOOR SINGLE DRAWER BASE CABINETS**



**SPECIFICATIONS:**

- 1/2 DEPTH ADJUSTABLE SHELF

ITEM	SIZES	ASP	HS	NG	PS	WPG	WS	MBS	FS	CS	RH
FHB24	24 x 34.5 x 24	N/A	N/A	N/A	N/A	N/A	\$496.94	\$496.94	\$496.94	\$496.94	N/A
FHB27	27 x 34.5 x 24	N/A	N/A	N/A	N/A	N/A	\$536.68	\$536.68	\$536.68	\$536.68	N/A
FHB30	30 x 34.5 x 24	N/A	N/A	N/A	N/A	N/A	\$617.32	\$617.32	\$617.32	\$617.32	N/A
FHB33	33 x 34.5 x 24	N/A	N/A	N/A	N/A	N/A	\$649.95	\$649.95	\$649.95	\$649.95	N/A
FHB36	36 x 34.5 x 24	N/A	N/A	N/A	N/A	N/A	\$680.61	\$680.61	\$680.61	\$680.61	N/A
FHB39	39 x 34.5 x 24	N/A	N/A	N/A	N/A	N/A	\$732.61	\$732.61	\$732.61	\$732.61	N/A
FHB42	42 x 34.5 x 24	N/A	N/A	N/A	N/A	N/A	\$755.41	\$755.41	\$755.41	\$755.41	N/A
FHB48	48 x 34.5 x 24	N/A	N/A	N/A	N/A	N/A	\$808.33	\$808.33	\$808.33	\$808.33	N/A

**DOUBLE DOOR SINGLEDRAWER BASE CABINETS**



**SPECIFICATIONS:**

- 1/2 DEPTH ADJUSTABLE SHELF
- BUTT DOORS ON 24", 27", 30", 33", AND 36" WIDE BASES

ITEM	SIZES	ASP	HS	NG	PS	WPG	WS	MBS	FS	CS	RH
DB12	12 x 34.5 x 24	\$688.18	\$684.39	\$684.39	\$655.41	\$684.39	\$655.41	\$688.18	\$688.18	\$701.29	\$684.39
DB15	15 x 34.5 x 24	\$715.44	\$709.04	\$709.04	\$681.37	\$709.04	\$681.37	\$715.44	\$715.44	\$729.07	\$709.04
DB18	18 x 34.5 x 24	\$734.40	\$723.66	\$723.66	\$699.43	\$723.66	\$699.43	\$734.40	\$734.40	\$748.39	\$723.66
DB21	21 x 34.5 x 24	\$791.95	\$782.50	\$782.50	\$754.24	\$782.50	\$754.24	\$791.95	\$791.95	\$807.04	\$782.50
DB24	24 x 34.5 x 24	\$845.36	\$832.61	\$832.61	\$805.10	\$832.61	\$805.10	\$845.36	\$845.36	\$861.46	\$832.61
DB30	30 x 34.5 x 24	\$995.47	\$994.43	\$994.43	\$948.07	\$994.43	\$948.07	\$995.47	\$995.47	\$1,014.43	\$994.43
DB36	36 x 34.5 x 24	\$1,137.52	\$1,131.86	\$1,131.86	\$1,083.35	\$1,131.86	\$1,083.35	\$1,137.52	\$1,137.52	\$1,159.18	\$1,131.86

**DOUBLE DOOR & DRAWERS BASE CABINETS**



**SPECIFICATIONS:**

- 1/2 DEPTH ADJUSTABLE SHELF
- BUTT DOORS ON 24", 27", 30", 33", AND 36" WIDE BASES

ITEM	SIZES	ASP	HS	NG	PS	WPG	WS	MBS	FS	CS	RH
B30	30 x 34.5 x 24	\$648.19	\$645.41	\$645.41	\$617.32	\$645.41	\$617.32	\$648.19	\$648.19	\$660.53	\$645.41
B33	33 x 34.5 x 24	\$682.45	\$673.47	\$673.47	\$649.95	\$673.47	\$649.95	\$682.45	\$682.45	\$695.00	\$673.47
B36	36 x 34.5 x 24	\$714.64	\$706.40	\$706.40	\$680.61	\$706.40	\$680.61	\$714.64	\$714.64	\$728.25	\$706.40
B39	39 x 34.5 x 24	\$769.24	\$754.15	\$754.15	\$732.61	\$754.15	\$732.61	\$769.24	\$769.24	\$783.89	\$754.15
B42	42 x 34.5 x 24	\$793.18	\$778.34	\$778.34	\$755.41	\$778.34	\$755.41	\$793.18	\$793.18	\$808.29	\$778.34
B48	48 x 34.5 x 24	\$848.75	\$833.28	\$833.28	\$808.33	\$833.28	\$808.33	\$848.75	\$848.75	\$864.91	\$833.28

**SINGLE DOOR FULL HEIGHT BASE CABINET**



**SPECIFICATIONS:**

- 1/2 DEPTH ADJUSTABLE SHELF

ITEM	SIZES	ASP	HS	NG	PS	WPG	WS	MBS	FS	CS	RH
TB09	9 x 34.5 x 24	\$376.44	\$358.51	\$358.51	\$358.51	\$358.51	\$358.51	\$376.44	\$376.44	\$383.61	\$358.51

## DOUBLE DOOR FULL HEIGHT BASE CABINETS

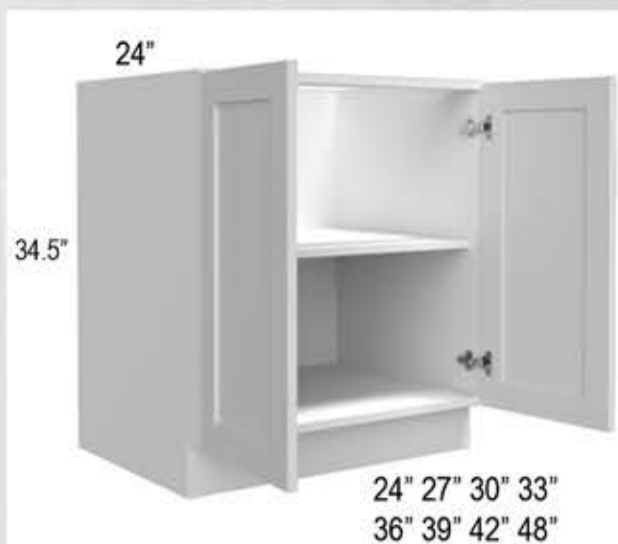

### SPECIFICATIONS:

- 1/2 DEPTH ADJUSTABLE SHELF
- BUTT DOORS ON 24", 27", 30", 33", AND 36" WIDE BASES

ITEM	SIZES	ASP	HS	NG	PS	WPG	WS	MBS	FS	CS	RH
FHB24	24 x 34.5 x 24	N/A	N/A	N/A	N/A	N/A	\$496.94	\$496.94	\$496.94	\$496.94	N/A
FHB27	27 x 34.5 x 24	N/A	N/A	N/A	N/A	N/A	\$536.68	\$536.68	\$536.68	\$536.68	N/A
FHB30	30 x 34.5 x 24	N/A	N/A	N/A	N/A	N/A	\$617.32	\$617.32	\$617.32	\$617.32	N/A
FHB33	33 x 34.5 x 24	N/A	N/A	N/A	N/A	N/A	\$649.95	\$649.95	\$649.95	\$649.95	N/A
FHB36	36 x 34.5 x 24	N/A	N/A	N/A	N/A	N/A	\$680.61	\$680.61	\$680.61	\$680.61	N/A
FHB39	39 x 34.5 x 24	N/A	N/A	N/A	N/A	N/A	\$732.61	\$732.61	\$732.61	\$732.61	N/A
FHB42	42 x 34.5 x 24	N/A	N/A	N/A	N/A	N/A	\$755.41	\$755.41	\$755.41	\$755.41	N/A
FHB48	48 x 34.5 x 24	N/A	N/A	N/A	N/A	N/A	\$808.33	\$808.33	\$808.33	\$808.33	N/A

## DRAWER BASE CABINETS



### SPECIFICATIONS:

- ALL DRAWER BASES HAVE A SMALL TOP DRAWER AND TWO LARGER BOTTOM DRAWERS

ITEM	SIZES	ASP	HS	NG	PS	WPG	WS	MBS	FS	CS	RH
DB12	12 x 34.5 x 24	\$688.18	\$684.39	\$684.39	\$655.41	\$684.39	\$655.41	\$688.18	\$688.18	\$701.29	\$684.39
DB15	15 x 34.5 x 24	\$715.44	\$709.04	\$709.04	\$681.37	\$709.04	\$681.37	\$715.44	\$715.44	\$729.07	\$709.04
DB18	18 x 34.5 x 24	\$734.40	\$723.66	\$723.66	\$699.43	\$723.66	\$699.43	\$734.40	\$734.40	\$748.39	\$723.66
DB21	21 x 34.5 x 24	\$791.95	\$782.50	\$782.50	\$754.24	\$782.50	\$754.24	\$791.95	\$791.95	\$807.04	\$782.50
DB24	24 x 34.5 x 24	\$845.36	\$832.61	\$832.61	\$805.10	\$832.61	\$805.10	\$845.36	\$845.36	\$861.46	\$832.61
DB30	30 x 34.5 x 24	\$995.47	\$994.43	\$994.43	\$948.07	\$994.43	\$948.07	\$995.47	\$995.47	\$1,014.43	\$994.43
DB36	36 x 34.5 x 24	\$1,137.52	\$1,131.86	\$1,131.86	\$1,083.35	\$1,131.86	\$1,083.35	\$1,137.52	\$1,137.52	\$1,159.18	\$1,131.86



## 2 DRAWER BASE CABINETS

### SPECIFICATIONS:

- TWO EQUAL SIZED DEEP DOVETAIL DRAWERS

ITEM	SIZES	ASP	HS	NG	PS	WPG	WS	MBS	FS	CS	RH
2DB24	24 x 34.5 x 24	N/A	\$1,109.03	\$1,109.03	\$764.85	\$1,109.03	\$764.85	\$803.09	\$803.09	\$818.39	\$1,109.03
2DB27	27 x 34.5 x 24	N/A	\$1,207.50	\$1,207.50	\$832.76	\$1,207.50	\$832.76	\$874.40	\$874.40	\$891.05	\$1,207.50
2DB30	30 x 34.5 x 24	N/A	\$1,305.97	\$1,305.97	\$900.67	\$1,305.97	\$900.67	\$945.70	\$945.70	\$963.72	\$1,305.97
2DB33	33 x 34.5 x 24	N/A	\$1,399.14	\$1,399.14	\$964.93	\$1,399.14	\$964.93	\$1,013.18	\$1,013.18	\$1,032.48	\$1,399.14
2DB36	36 x 34.5 x 24	N/A	\$1,492.31	\$1,492.31	\$1,029.18	\$1,492.31	\$1,029.18	\$1,080.64	\$1,080.64	\$1,102.22	\$1,492.31



## FULL HEIGHT/ TRAY BASE CABINET

### SPECIFICATIONS:

- THERE ARE NO SHELVES IN THIS CABINET OR TOP DRAWER
- GOOD FOR TRAYS & COOKIE SHEETS

ITEM	SIZES	ASP	HS	NG	PS	WPG	WS	MBS	FS	CS	RH
TB09	9 x 34.5 x 24	\$376.44	\$358.51	\$358.51	\$358.51	\$358.51	\$358.51	\$376.44	\$376.44	\$383.61	\$358.51

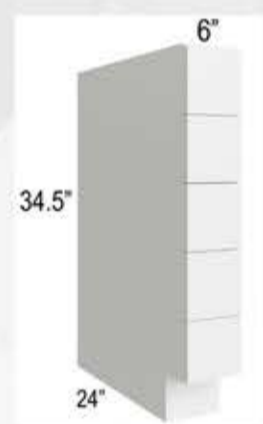

## BASE SPICE DRAWERS CABINET

### SPECIFICATIONS:

- THIS CABINET DOES NOT COME WITH ANY DRAWER SLIDES
- THE CABINET CAN BE USED WITHOUT THE DRAWERS AS A WINE RACK

ITEM	SIZES	ASP	HS	NG	PS	WPG	WS	MBS	FS	CS	RH
BSD6	6 x 34.5 x 24	\$433.24	\$412.61	\$412.61	\$412.61	\$412.61	\$412.61	\$433.24	\$433.24	\$441.49	\$412.61



## BASE SPICE RACK CABINETS

### SPECIFICATIONS:

- BSR9 HAS 5 7/8" WIDE OPENING, BSR12 HAS 8 7/8" WIDE OPENING
- FULL HEIGHT DOOR
- 3 FIXED SHELVES (PULL OUT WITH DOOR)
- SOFT CLOSE, SIDE-MOUNT BALL-BEARING GUIDES ON ALL DOOR STYLES
- UNDERMOUNT GUIDES NOT AVAILABLE

ITEM	SIZES	ASP	HS	NG	PS	WPG	WS	MBS	FS	CS	RH
BSR9	9 x 34.5 x 24	N/A	\$712.82	\$712.82	\$491.60	\$712.82	\$491.60	\$516.18	\$516.18	\$526.01	\$712.82
BSR12	12 x 34.5 x 24	N/A	\$816.79	\$816.79	\$563.30	\$816.79	\$563.30	\$591.47	\$591.47	\$602.73	\$816.79



# SINK BASE CABINETS

- SPECIFICATIONS:**
- THERE ARE NO SHELVES IN THIS CABINET
  - THERE ARE NO DRAWERS IN THIS CABINET
  - BUTT DOORS ON THIS 33" OR 36" WIDE CABINET
  - ANY BASE MAY BE USED AS A SINK BASE BY SIMPLY NOT INSTALLING THE DRAWER HARDWARE AND ATTACHING ONLY THE DRAWER FACES TO THE CABINET AS FALSE FRONTS

ITEM	SIZES	ASP	HS	NG	PS	WPG	WS	MBS	FS	CS	RH
SB33	33 x 34.5 x 24	\$572.75	\$649.91	\$649.91	\$545.00	\$649.91	\$545.00	\$572.25	\$572.25	\$583.15	\$649.91
SB36	36 x 34.5 x 24	\$582.74	\$659.90	\$659.90	\$554.99	\$659.90	\$554.99	\$582.74	\$582.74	\$593.84	\$659.90



# FARM SINK BASE CABINET

- SPECIFICATIONS:**
- 18" HIGH CABINET DOORS
  - THERE ARE NO SHELVES OR DRAWERS IN THIS CABINET

ITEM	SIZES	ASP	HS	NG	PS	WPG	WS	MBS	FS	CS	RH
FBS36	36 x 34.5 x 24	\$582.74	\$659.90	\$659.90	\$554.99	\$659.90	\$554.99	\$582.74	\$582.74	\$593.84	\$659.90



# DIAGONAL CORNER SINK BASE CABINET

- SPECIFICATIONS:**
- THERE ARE NO SHELVES IN THIS CABINET
  - THERE ARE NO DRAWERS IN THIS CABINET

ITEM	SIZES	ASP	HS	NG	PS	WPG	WS	MBS	FS	CS	RH
DCSB36	36 X 34.5 X 24	\$547.50	\$521.43	\$521.43	\$521.43	\$521.43	\$521.43	\$547.50	\$547.50	\$557.93	\$521.43



# LAZY SUSAN CORNER BASE CABINETS

- SPECIFICATIONS:**
- STAINLESS STEEL BASKETS ARE STANDARD
  - THERE ARE TWO BASKETS PER CABINET
  - BOTH BASKETS ARE HEIGHT ADJUSTABLE
  - LAZY SUSAN DOORS MAY BE MOUNTED TO OPEN RIGHT OR LEFT

ITEM	SIZES	ASP	HS	NG	PS	WPG	WS	MBS	FS	CS	RH
LS3312	33 x 34.5 x 24	\$1,117.37	\$1,117.37	\$1,117.37	\$778.81	\$1,117.37	\$778.81	\$856.69	\$856.69	\$872.27	\$1,117.37
LS3612	36 x 34.5 x 24	\$1,127.36	\$1,127.36	\$1,127.36	\$788.80	\$1,127.36	\$788.80	\$867.68	\$867.68	\$883.46	\$1,127.36



## BLIND CORNER BASE CABINET

### SPECIFICATIONS:

- ADJUSTABLE TO 45" WIDE
- MAY NOT BE PULLED FARTHER THAN 9"
- 12 7/8" DOOR OVERLAYS 11 7/8" FRAME OPENING
- MAY BE USED AS A RIGHT (R) OR LEFT (L) BLIND SETUP
- FULL OVERLAY CABINETS MUST BE PULLED A MINIMUM OF 4" AND REMAINING STYLES MUST BE PULLED A MINIMUM OF 3"
- MAY BE NECESSARY TO PULL FURTHER TO ALLOW CLEARANCE FOR DOOR AND DRAWER HARDWARE

ITEM	SIZES	ASP	HS	NG	PS	WPG	WS	MBS	FS	CS	RH
<b>BBC36</b>	<b>36 x 34.5 x 24</b>	<b>\$638.17</b>	<b>\$629.16</b>	<b>\$629.16</b>	<b>\$607.78</b>	<b>\$629.16</b>	<b>\$607.78</b>	<b>\$638.17</b>	<b>\$638.17</b>	<b>\$650.32</b>	<b>\$629.16</b>

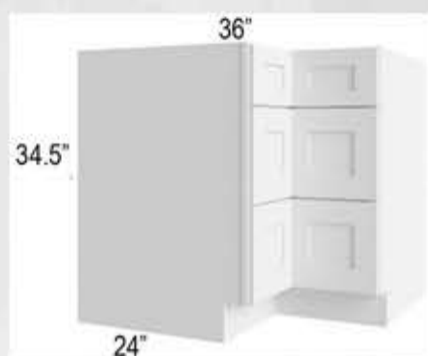

## CORNER DRAWER BASE CABINET

### SPECIFICATIONS:

- ALL DRAWER BASES HAVE A SMALL TOP DRAWER AND TWO LARGER BOTTOM DRAWERS

ITEM	SIZES	ASP	HS	NG	PS	WPG	WS	MBS	FS	CS	RH
<b>CDB36</b>	<b>36 x 34.5 x 24</b>	<b>\$982.55</b>	<b>\$990.30</b>	<b>\$935.76</b>	<b>\$935.76</b>	<b>\$935.76</b>	<b>\$935.76</b>	<b>\$982.55</b>	<b>\$982.55</b>	<b>\$1,001.26</b>	<b>\$990.30</b>



## ANGLED END BASE CABINET

### SPECIFICATIONS:

- ONE ADJUSTABLE SHELF

ITEM	SIZES	ASP	HS	NG	PS	WPG	WS	MBS	FS	CS	RH
<b>BA24</b>	<b>24 x 34.5 x 24</b>	<b>\$583.66</b>	<b>\$579.47</b>	<b>\$579.47</b>	<b>\$555.87</b>	<b>\$579.47</b>	<b>\$555.87</b>	<b>\$583.66</b>	<b>\$583.66</b>	<b>\$594.78</b>	<b>\$579.47</b>

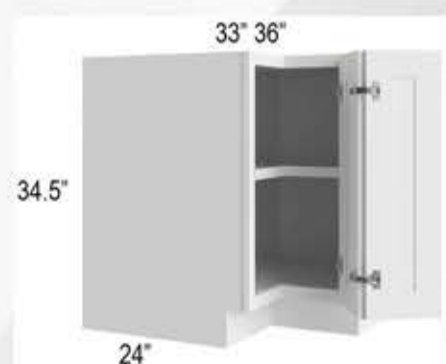

## EASY REACH BASE CABINETS

### SPECIFICATIONS:

- ONE FULL DEPTH SHELF

ITEM	SIZES	ASP	HS	NG	PS	WPG	WS	MBS	FS	CS	RH
<b>BER33</b>	<b>33 x 34.5 x 24</b>	<b>N/A</b>	<b>\$1,072.81</b>	<b>\$1,072.81</b>	<b>\$739.87</b>	<b>\$1,072.81</b>	<b>\$739.87</b>	<b>\$776.86</b>	<b>\$776.86</b>	<b>\$791.66</b>	<b>\$1,072.81</b>
<b>BER36</b>	<b>36 x 34.5 x 24</b>	<b>N/A</b>	<b>\$1,086.57</b>	<b>\$1,086.57</b>	<b>\$749.36</b>	<b>\$1,086.57</b>	<b>\$749.36</b>	<b>\$786.83</b>	<b>\$786.83</b>	<b>\$801.82</b>	<b>\$1,086.57</b>

# PANTRY / UTILITY

C A B I N E T S



**TOP WALL CABINET FOR SPLIT PANTRIES**

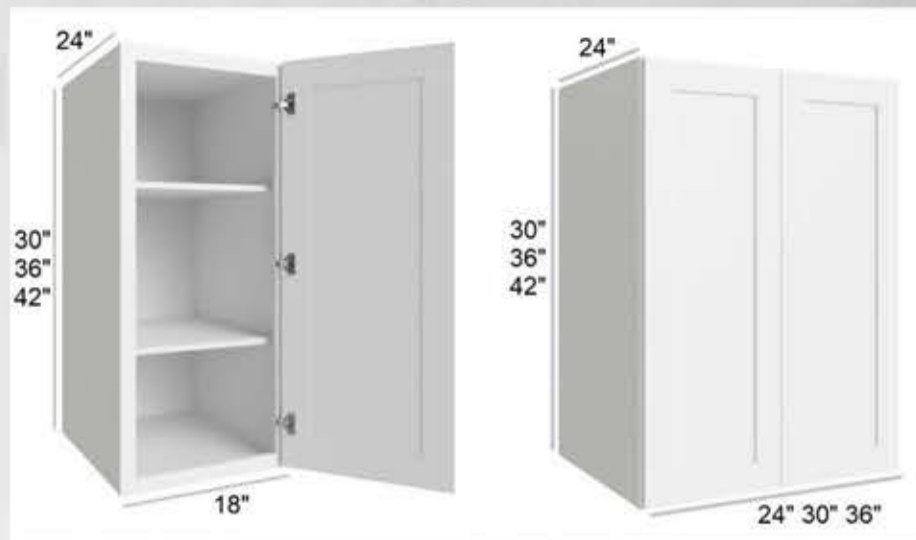

**SPECIFICATIONS:**

- FOUR ADJUSTABLE SHELVES CAN BE USED IN EITHER THE TOP OR BOTTOM SECTION.
- THESE CABINETS ARE 24" DEEP.
- WILL REQUIRE A TALL SKIN TO COVER THE SEAM
- 30" & 36" HAS 2 ADJUSTABLE SHELVES
- 42" HAS 3 ADJUSTABLE SHELVES (PAGE 5)

ITEM	SIZES	ASP	HS	NG	PS	WPG	WS	MBS	FS	CS	RH
W243024	24 x 30 x 24	N/A	\$769.31	\$769.31	\$530.56	\$769.31	\$530.56	\$557.09	\$557.09	\$567.70	\$769.31
W243624	24 x 36 x 24	N/A	\$850.86	\$850.86	\$586.80	\$850.86	\$586.80	\$616.14	\$616.14	\$627.88	\$850.86
W244224	24 x 42 x 24	N/A	\$932.99	\$932.99	\$643.44	\$932.99	\$643.44	\$675.61	\$675.61	\$688.48	\$932.99
W303024	30 x 30 x 24	N/A	\$900.86	\$900.86	\$621.28	\$900.86	\$621.28	\$652.34	\$652.34	\$664.77	\$900.86
W303624	30 x 36 x 24	N/A	\$994.12	\$994.12	\$685.60	\$994.12	\$685.60	\$719.88	\$719.88	\$733.59	\$994.12
W304224	30 x 42 x 24	N/A	\$1,087.96	\$1,087.96	\$750.32	\$1,087.96	\$750.32	\$787.84	\$787.84	802.84	\$1,087.96
W363024	36 x 30 x 24	N/A	\$1,032.40	\$1,032.40	\$712.00	\$1,032.40	\$712.00	\$747.60	\$747.60	\$761.84	\$1,032.40
W363624	36 x 36 x 24	N/A	\$1,137.38	\$1,137.38	\$784.40	\$1,137.38	\$784.40	\$823.62	\$823.62	\$839.31	\$1,137.38
W364224	36 x 42 x 24	N/A	\$1,242.94	\$1,242.94	\$857.20	\$1,242.94	\$857.20	\$900.06	\$900.06	\$917.20	\$1,242.94

**BOTTOM WALL CABINET FOR SPLIT PANTRIES**



**SPECIFICATIONS:**

- TWO ADJUSTABLE SHELVES CAN BE USED IN EITHER THE TOP OR BOTTOM SECTION.
- THESE CABINETS ARE 24" DEEP.
- WILL REQUIRE A TALL SKIN TO COVER THE SEAM

ITEM	SIZES	ASP	HS	NG	PS	WPG	WS	MBS	FS	CS	RH
UCB1854	18 x 54 x 24	N/A	\$932.87	\$932.87	\$643.36	\$932.87	\$643.36	\$675.53	\$675.53	\$675.53	\$932.87
UCB2454	24 x 54 x 24	N/A	\$1,167.19	\$1,167.19	\$804.96	\$1,167.19	\$804.96	\$845.21	\$845.21	\$861.31	\$1,167.19
UCB3054	30 x 54 x 24	N/A	\$1,360.56	\$1,360.56	\$938.32	\$1,360.56	\$938.32	\$985.24	\$985.24	\$1,004.00	\$1,360.56
UCB3654	36 x 54 x 24	N/A	\$1,553.82	\$1,553.82	\$1,071.60	\$1,553.82	\$1,071.60	\$1,125.18	\$1,125.18	\$1,146.61	\$1,553.82

### SINGLE DOOR UTILITY CABINETS

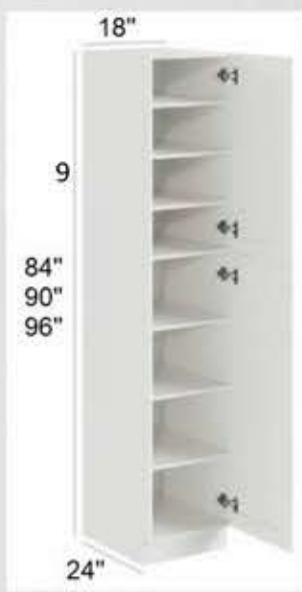

### SPECIFICATIONS:

- FOUR ADJUSTABLE SHELVES CAN BE USED IN EITHER THE TOP OR BOTTOM SECTION.
- BOTTOM SECTION MEASURES 54" TALL.
- THESE CABINETS ARE 24" DEEP.



ITEM	SIZES	ASP	HS	NG	PS	WPG	WS	MBS	FS	CS	RH
UC1884	18 x 84 x 24	\$1,073.34	\$1,156.51	\$1,156.51	\$984.35	\$1,156.51	\$984.35	\$1,082.79	\$1,082.79	\$1,102.47	\$1,156.51
UC1890	18 x 90 x 24	\$1,127.07	\$1,213.63	\$1,213.63	\$1,031.35	\$1,213.63	\$1,031.35	\$1,134.49	\$1,134.49	\$1,155.11	\$1,213.63
UC1896	18 x 96 x 24	\$1,181.86	\$1,292.97	\$1,292.97	\$1,080.16	\$1,292.97	\$1,080.16	\$1,188.18	\$1,188.18	\$1,209.79	\$1,292.97

### DOUBLE DOOR WIDE UTILITY CABINETS



### SPECIFICATIONS:

- FOUR ADJUSTABLE SHELVES CAN BE USED IN EITHER THE TOP OR BOTTOM SECTION.
- BOTTOM SECTION MEASURES 54" TALL.
- THESE CABINETS ARE 24" DEEP.

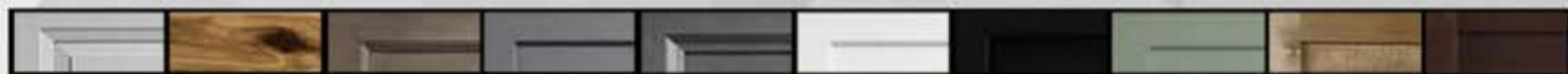

ITEM	SIZES	ASP	HS	NG	PS	WPG	WS	MBS	FS	CS	RH
UC2484	24 x 84 x 24	\$1,251.52	\$1,203.97	\$1,203.97	\$1,148.07	\$1,203.97	\$1,148.07	\$1,262.88	\$1,262.88	\$1,285.84	\$1,203.97
UC2490	24 x 90 x 24	\$1,238.85	\$1,246.56	\$1,246.56	\$1,179.86	\$1,246.56	\$1,179.86	\$1,297.85	\$1,297.85	\$1,321.44	\$1,246.56
UC2496	24 x 96 x 24	\$1,273.57	\$1,342.53	\$1,342.53	\$1,212.92	\$1,342.53	\$1,212.92	\$1,334.21	\$1,334.21	\$1,358.47	\$1,342.53

### UNIVERSAL OVEN CABINETS



### SPECIFICATIONS:

- THE CUT OUT OPENING MEASURES 28.5" X 22".
- WILL FIT ANY STANDARD SIZE OVEN.
- THESE CABINETS ARE 24" DEEP.
- CAN BE ARRANGED AS A SINGLE OVEN, DOUBLE OVEN, OR OVEN/MICROWAVE COMBINATION BY REMOVING THE NECESSARY DRAWERS AND CUTTING TO FIT.
- BUTT DOORS ON ALL UNIVERSAL OVEN CABINETS.
- THE TOP TWO DRAWERS ARE STANDARD DRAWERS WHILE THE BOTTOM IS A DEEPER DRAWER.

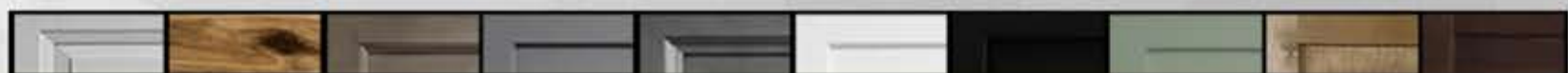

ITEM	SIZES	ASP	HS	NG	PS	WPG	WS	MBS	FS	CS	RH
UOC3384	33 x 84 x 24	\$1,575.87	\$1,434.51	\$1,421.95	\$1,468.66	\$1,421.95	\$1,468.66	\$1,615.53	\$1,615.53	\$1,644.90	\$1,434.51
UOC3390	33 x 90 x 24	\$1,693.97	\$1,447.15	\$1,447.15	\$1,500.83	\$1,447.15	\$1,500.83	\$1,650.91	\$1,650.91	\$1,680.93	\$1,447.15
UOC3396	33 x 96 x 24	\$1,726.71	\$1,596.71	\$1,596.71	\$1,546.27	\$1,596.71	\$1,546.27	\$1,700.90	\$1,700.90	\$1,731.82	\$1,596.71

# VANITY

C A B I N E T S



### VANITY BASE



### SPECIFICATIONS:

- ONE STANDARD HEIGHT DOVETAIL DRAWER
- ONE DOOR
- ONE 1/2 DEPTH ADJUSTABLE SHELF

ITEM	SIZES	ASP	HS	NG	PS	WPG	WS	MBS	FS	CS	RH
VB12	12 x 34.5 x 21	N/A	\$554.36	\$554.36	\$382.32	\$554.36	\$382.32	\$401.44	\$401.44	\$409.08	\$554.36
VB15	15 x 34.5 x 21	N/A	\$610.86	\$610.86	\$421.28	\$610.86	\$421.28	\$442.34	\$442.34	\$450.77	\$610.86
VB18	18 x 34.5 x 21	N/A	\$667.23	\$667.23	\$460.16	\$667.23	\$460.16	\$483.17	\$483.17	\$492.37	\$667.23

### VANITY SINK BASE CABINETS



### SPECIFICATIONS:

- THERE ARE NO SHELVES OR DRAWERS IN THESE CABINETS
- BUTT DOORS ON ALL THREE VANITY SINK BASES
- DEPTH: 21"

ITEM	SIZES	ASP	HS	NG	PS	WPG	WS	MBS	FS	CS	RH
V2121	21 x 34.5 x 21	\$497.72	\$497.72	\$497.72	\$398.51	\$497.72	\$398.51	\$418.44	\$418.44	\$426.41	\$497.72
V2421	24 x 34.5 x 21	\$536.76	\$536.76	\$536.76	\$432.94	\$536.76	\$432.94	\$454.59	\$454.59	\$463.25	\$536.76
V2721	27 x 34.5 x 21	\$640.83	\$640.83	\$640.83	\$485.17	\$640.83	\$485.17	\$509.43	\$509.43	\$519.13	\$640.83
V3021	30 x 34.5 x 21	\$534.80	\$631.43	\$631.43	\$509.33	\$631.43	\$509.33	\$534.80	\$534.80	\$544.98	\$631.43
V3621	36 x 34.5 x 21	\$795.83	\$797.20	\$797.20	\$757.93	\$797.20	\$757.93	\$795.83	\$795.83	\$810.99	\$797.20

### VANITY DRAWERS BASE CABINETS



### SPECIFICATIONS:

- DEPTH: 21"
- ALL STYLES HAVE ONE STANDARD DRAWER ON TOP AND TWO DEEP DRAWERS BELOW.
- ALL THREE DRAWERS ARE FULLY FUNCTIONING.

ITEM	SIZES	ASP	HS	NG	PS	WPG	WS	MBS	FS	CS	RH
VDB1221	12 x 34.5 x 21	\$573.75	\$600.89	\$600.89	\$495.43	\$600.89	\$495.43	\$520.20	\$520.20	\$530.11	\$600.89
VDB1521	15 x 34.5 x 21	\$602.44	\$630.93	\$630.93	\$520.20	\$630.93	\$520.20	\$546.21	\$546.21	\$556.61	\$630.93
VDB1821	18 x 34.5 x 21	\$632.55	\$662.48	\$662.48	\$546.21	\$662.48	\$546.21	\$573.52	\$573.52	\$584.44	\$662.48
VDB2121	21 x 34.5 x 21	\$698.16	\$698.16	\$698.16	\$600.86	\$698.16	\$600.86	\$630.90	\$630.90	\$642.92	\$698.16
VDB2421	24 x 34.5 x 21	\$731.44	\$731.44	\$731.44	\$616.00	\$731.44	\$616.00	\$646.80	\$646.80	\$659.12	\$731.44

### DOUBLE DOOR VANITY CABINETS



### SPECIFICATIONS:

- DEPTH: 21"
- THERE ARE NO SHELVES IN THESE CABINETS.
- ALL SIX DRAWERS ARE FULLY FUNCTIONING.
- ALL STYLES HAVE TWO STANDARD DRAWERS ON TOP AND FOUR DEEP DRAWERS BELOW.
- BUTT DOORS ON BOTH VANITY COMBINATIONS.

ITEM	SIZES	ASP	HS	NG	PS	WPG	WS	MBS	FS	CS	RH
V4821DD	48 x 34.5 x 21	\$1,087.68	\$1,328.45	\$1,035.89	\$1,035.89	\$1,035.89	\$1,035.89	\$1,087.68	\$1,087.68	\$1,108.40	\$1,328.45
V6021DD	60 x 34.5 x 21	\$1,112.60	\$1,498.01	\$1,148.15	\$1,059.62	\$1,148.15	\$1,059.62	\$1,112.60	\$1,112.60	\$1,133.79	\$1,498.01

## SINGLE DOOR VANITY CABINETS

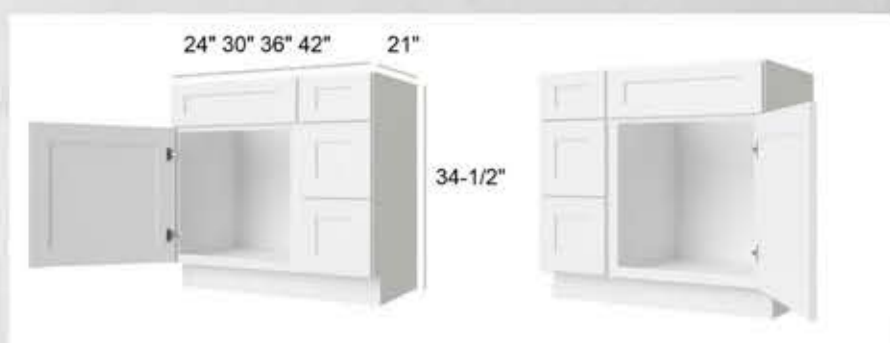

### SPECIFICATIONS:

- DEPTH: 21".
- THERE ARE NO SHELVES IN THESE CABINETS.
- ONLY THE BOTTOM TWO DRAWERS ARE FUNCTIONING.
- 24" HAS ONE STANDARD FALSE DRAWER ON TOP AND 2 DEEP DRAWERS BELOW. ALL OTHER SIZES HAVE TWO FALSE DRAWERS ON TOP AND 2 DEEP DRAWERS BELOW.
- WHEN INDICATING RIGHT (R) OR LEFT (L), IT CORRESPONDS TO THE SIDE THE DRAWERS ARE ON WHILE LOOKING AT IT

ITEM	SIZES	ASP	HS	NG	PS	WPG	WS	MBS	FS	CS	RH
V2421DL	24 x 34.5 x 21 left	\$508.53	\$543.26	\$508.53	\$502.73	\$508.53	\$502.73	\$527.87	\$527.87	\$537.92	\$543.26
V2421DR	24 x 34.5 x 21 right	\$508.53	\$543.26	\$508.53	\$502.73	\$508.53	\$502.73	\$527.87	\$527.87	\$537.92	\$543.26
V3021DL	30 x 34.5 x 21 left	\$677.07	\$688.88	\$644.83	\$644.83	\$644.83	\$644.83	\$677.07	\$677.07	\$689.97	\$688.88
V3021DR	30 x 34.5 x 21 right	\$677.07	\$688.88	\$644.83	\$644.83	\$644.83	\$644.83	\$677.07	\$677.07	\$689.97	\$688.88
V3621DL	36 x 34.5 x 21 left	\$865.20	\$824.00	\$824.00	\$824.00	\$824.00	\$824.00	\$865.20	\$865.20	\$881.68	\$824.00
V3621DR	36 x 34.5 x 21 right	\$865.20	\$824.00	\$824.00	\$824.00	\$824.00	\$824.00	\$865.20	\$865.20	\$881.68	\$824.00
V4221DL	42 x 34.5 x 21 left	N/A	\$977.42	\$977.42	\$977.42	\$977.42	\$977.42	\$1,026.29	\$1,026.29	\$1,045.84	\$977.42
V4221DR	42 x 34.5 x 21 right	N/A	\$977.42	\$977.42	\$977.42	\$977.42	\$977.42	\$1,026.29	\$1,026.29	\$1,045.84	\$977.42

## DOUBLE SINK VANITY CABINET



### SPECIFICATIONS:

- DEPTH: 21".
- THERE ARE NO SHELVES IN THIS CABINETS.

ITEM	SIZES	ASP	HS	NG	PS	WPG	WS	MBS	FS	CS	RH
VSDB60	60 x 34.5 x 21	\$1,112.60	\$1,498.01	\$1,148.15	\$1,059.62	\$1,148.15	\$1,059.62	\$1112.60	\$1112.60	\$1133.79	\$1,498.01

# ADA

C A B I N E T S





### ADA SINGLE DOOR SINGLE DRAWER BASE CABINETS

### SPECIFICATIONS:

- 1/2 DEPTH ADJUSTABLE SHELF

ITEM	SIZES	WS
<b>ADAB12</b>	<b>12 x 32.5 x 24</b>	<b>\$488.12</b>
<b>ADAB15</b>	<b>15 x 32.5 x 24</b>	<b>\$513.02</b>
<b>ADAB18</b>	<b>18 x 32.5 x 24</b>	<b>\$527.22</b>
<b>ADAB21</b>	<b>21 x 32.5 x 24</b>	<b>\$593.13</b>

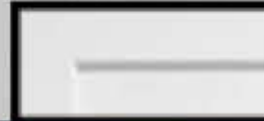

### ADA DOUBLE DOOR SINGLE DRAWER BASE CABINETS

### SPECIFICATIONS:

- 1/2 DEPTH ADJUSTABLE SHELF.
- BUTT DOORS ON BOTH 24" AND 27" WIDE BASES.

ITEM	SIZES	WS
<b>ADAB24</b>	<b>24 x 32.5 x 24</b>	<b>\$646.02</b>
<b>ADAB27</b>	<b>27 x 32.5 x 24</b>	<b>\$697.68</b>

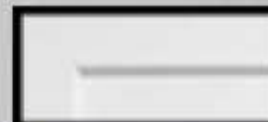

### ADA DOUBLE DOORS & DRAWERS BASE CABINETS

### SPECIFICATIONS:

- 1/2" DEPTH ADJUSTABLE SHELF.
- BUTT DOORS ON 30" THROUGH 36" WIDE BASES.

ITEM	SIZES	WS
<b>ADAB30</b>	<b>30 x 32.5 x 24</b>	<b>\$802.52</b>
<b>ADAB33</b>	<b>33 x 32.5 x 24</b>	<b>\$844.94</b>
<b>ADAB36</b>	<b>36 x 32.5 x 24</b>	<b>\$884.79</b>
<b>ADAB39</b>	<b>39 x 32.5 x 24</b>	<b>\$952.39</b>
<b>ADAB42</b>	<b>42 x 32.5 x 24</b>	<b>\$982.03</b>
<b>ADAB48</b>	<b>48 x 32.5 x 24</b>	<b>\$1,050.83</b>



### ADA DRAWERS BASE CABINETS

### SPECIFICATIONS:

- ALL DRAWER BASES HAVE A SMALL TOP DRAWER AND TWO LARGER BOTTOM DRAWERS.

ITEM	SIZES	WS
<b>ADADB18</b>	<b>18 x 32.5 x 24</b>	<b>\$909.26</b>
<b>ADADB21</b>	<b>21 x 32.5 x 24</b>	<b>\$980.51</b>



**ADA SINK BASE CABINET**



**SPECIFICATIONS:**

- THERE ARE NO SHELVES IN THIS CABINET.
- THERE ARE NO DRAWERS IN THIS CABINET.
- BUTT DOORS ON THIS 36" WIDE CABINET.
- ANY BASE MAY BE USED AS A SINK BASE BY SIMPLY NOT INSTALLING THE DRAWER HARDWARE AND ATTACHING ONLY THE DRAWER FACES TO THE CABINET AS FALSE FRONTS.

ITEM	SIZES	WS
<b>ADASB36</b>	<b>36 x 32.5 x 24</b>	<b>\$721.49</b>

**ADA LAZY SUSAN CORNER CABINET**

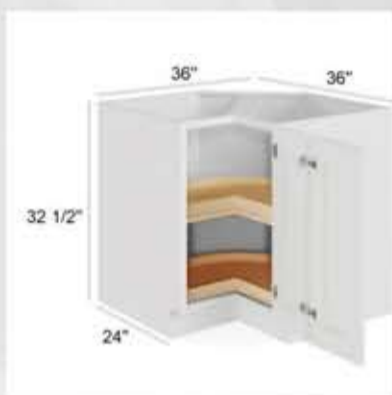

**SPECIFICATIONS:**

- STAINLESS STEEL BASKETS ARE STANDARD.
- THERE ARE TWO BASKETS PER CABINET.
- BOTH BASKETS ARE HEIGHT ADJUSTABLE.
- LAZY SUSAN DOORS MAY BE MOUNTED TO OPEN RIGHT OR LEFT.

ITEM	SIZES	WS
<b>ADALS3612</b>	<b>36 x 32.5 x 24</b>	<b>\$1,025.44</b>

**ADA BLIND CORNER BASE CABINET**



**SPECIFICATIONS:**

- ADJUSTABLE TO 45" WIDE.
- MAY NOT BE PULLED FARTHER THAN 9".
- 12 7/8" DOOR OVERLAYS 11 7/8" FRAME OPENING.
- MAY BE USED AS A RIGHT (R) OR LEFT (L) BLIND SETUP.
- FULL OVERLAY CABINETS MUST BE PULLED A MINIMUM OF 4" AND REMAINING STYLES MUST BE PULLED A MINIMUM OF 3". MAY BE NECESSARY TO PULL FURTHER TO ALLOW CLEARANCE FOR DOOR AND DRAWER HARDWARE.

ITEM	SIZES	WS
<b>ADABBC36</b>	<b>36 x 32.5 x 24</b>	<b>\$790.11</b>

**ADA VANITY SINK BASE CABINETS**



**SPECIFICATIONS:**

- THERE ARE NO SHELVES OR DRAWERS IN THESE CABINETS
- BUTT DOORS ON ALL THREE VANITY SINK BASES
- DEPTH: 21"

ITEM	SIZES	WS
<b>ADAV3021</b>	<b>30 x 32.5 x 24</b>	<b>\$662.13</b>
<b>ADAV3621</b>	<b>36 x 32.5 x 24</b>	<b>\$985.31</b>

**ADA DOUBLE DOOR VANITY CABINETS**



**SPECIFICATIONS:**

- DEPTH: 21".
- THERE ARE NO SHELVES IN THESE CABINETS.
- ALL SIX DRAWERS ARE FULLY FUNCTIONING.
- ALL STYLES HAVE TWO STANDARD DRAWERS ON TOP AND FOUR DEEP DRAWERS BELOW.
- BUTT DOORS ON THIS CABINET.

ITEM	SIZES	WS
<b>ADAV4821DD</b>	<b>48 x 32.5 x 24</b>	<b>\$1,346.66</b>

# ACCESSORIES



### WINE STORAGE CUBE



### SPECIFICATIONS:

- MATCHING FINISHED INTERIOR ON ALL DOOR STYLES
- ALL CUBES ARE 12" DEEP
- MUST BE INSTALLED BETWEEN TWO CABINETS, A CABINET AND A WALL, OR MOUNTED TO A HORIZONTAL SURFACE

ITEM	SIZES	ASP	HS	NG	PS	WPG	WS	MBS	FS	CS	RH
WSC1515	15 x 15 x 12	N/A	\$367.72	\$367.72	\$253.60	\$367.72	\$253.60	\$278.96	\$278.96	\$284.03	\$367.72
WSC1818	18 x 18 x 12	N/A	\$452.26	\$452.26	\$311.90	\$452.26	\$311.90	\$343.09	\$343.09	\$349.33	\$452.26

### LATTICE WINE RACK



### SPECIFICATIONS:

- HOLDS 11 BOTTLES.
- CAN BE INSTALLED HORIZONTALLY OR VERTICALLY.
- WILL HOLD 3-3/4" DIAMETER BOTTLES

ITEM	SIZES	ASP	HS	NG	PS	WPG	WS	MBS	FS	CS	RH
LWR3015	30 x 15 x 12	\$341.69	\$294.76	\$294.76	\$294.76	\$294.76	\$294.76	\$324.24	\$324.24	\$330.13	\$294.76

### STEM GLASS HOLDER



### SPECIFICATIONS:

- SOLID WOOD.
- MOUNTS TO BOTTOM OF WALL CABINET.
- CAN BE CUT TO FIT SMALLER CABINETS.
- FITTED TO MOUNT UNDER ANY 30" WIDE STANDARD, STACKER, OR BRIDGE WALL CABINET.

ITEM	SIZES	ASP	HS	NG	PS	WPG	WS	MBS	FS	CS	RH
SGH1230	12 x 30	\$249.69	\$249.69	\$249.69	\$249.69	\$249.69	\$249.69	\$274.66	\$274.66	\$279.65	\$249.69

### ARCHED VALANCE



### SPECIFICATIONS:

- CAN BE TRIMMED DOWN TO NEEDED SIZE

ITEM	SIZES	ASP	HS	NG	PS	WPG	WS	MBS	FS	CS	RH
VA48	48 x 4.5 x 0.75	\$174.99	\$166.66	\$166.66	\$166.66	\$166.66	\$166.66	\$183.33	\$183.33	\$186.66	\$166.66

**ROLL OUT TRAYS**



**SPECIFICATIONS:**

- ALL UNIVERSAL FITMENT WITH NATURAL BIRCH FINISH
- PARTIAL OVERLAY CABINET LINES: ORDER ACCORDING TO THE WIDTH OF THE CABINET.
- EX: ROT21 FITS B21 CABINET.
- FULL OVERLAY CABINET LINES: ORDER ACCORDING TO THE WIDTH OF THE CABINET IF IT IS NOT BEING INSTALLED BETWEEN HINGES. IF IT WILL BE INSTALLED BETWEEN HINGES THEN ORDER 1 SIZE SMALLER AND USE SHIMS FOR INSTALLATION (THIS IS DONE SO THE TRAY WILL CLEAR THE HINGES WHEN OPENING).
- DRAWER GLIDE HARDWARE AND WOOD FINISH FOR ROT ARE THE SAME AS THE STANDARD DRAWERS IN THEIR CORRESPONDING CABINET LINE.
- MAY BE USED IN ANY 24" DEEP CABINET (BASE, REFRIGERATOR WALL, PANTRIES).

ITEM	SIZES	UNIV
<b>ROT15</b>	<b>15"</b>	<b>\$105.68</b>
<b>ROT18</b>	<b>18"</b>	<b>\$117.15</b>
<b>ROT21</b>	<b>21"</b>	<b>\$121.76</b>
<b>ROT24</b>	<b>24"</b>	<b>\$127.42</b>
<b>ROT27</b>	<b>27"</b>	<b>\$136.83</b>
<b>ROT30</b>	<b>30"</b>	<b>\$148.41</b>
<b>ROT33</b>	<b>33"</b>	<b>\$161.49</b>
<b>ROT36</b>	<b>36"</b>	<b>\$171.69</b>

**FINISHED FLOATING SHELF**

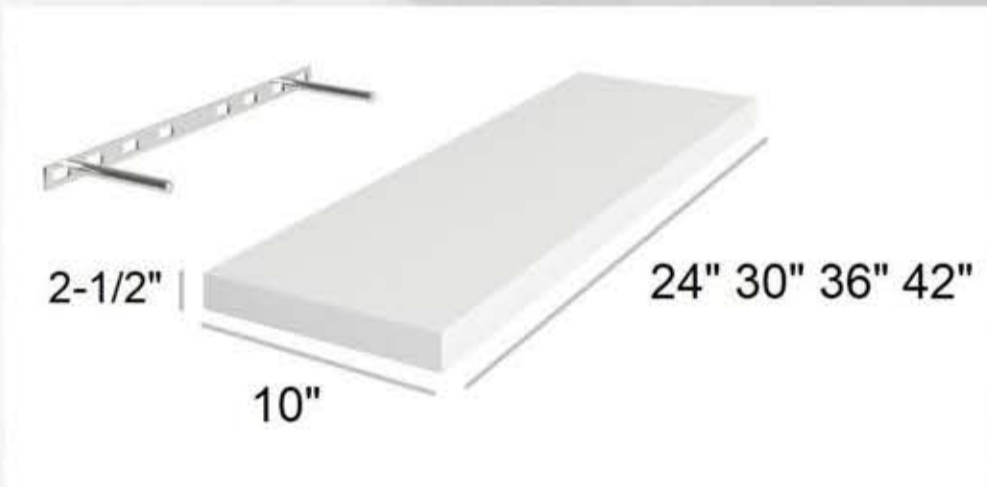

**SPECIFICATIONS:**

- NOT TRIMMABLE
- INSTALL AS FLOATING OR BETWEEN TWO CABINETS OR BETWEEN ONE CABINET AND A WALL
- FINISHED TO MATCH ON FRONT, SIDES, TOP, AND BOTTOM
- MAX LOAD = 15 LBS PER LINEAR FOOT

ITEM	SIZES	ASP	HS	NG	PS	WPG	WS	MBS	FS	CS	RH
<b>FFS24</b>	<b>24 x 2.5 x10</b>	<b>N/A</b>	<b>\$274.34</b>	<b>\$274.34</b>	<b>\$189.20</b>	<b>\$274.34</b>	<b>\$189.20</b>	<b>\$208.12</b>	<b>\$208.12</b>	<b>\$211.90</b>	<b>\$274.34</b>
<b>FFS30</b>	<b>30 x 2.5 x10</b>	<b>N/A</b>	<b>\$315.23</b>	<b>\$315.23</b>	<b>\$217.40</b>	<b>\$315.23</b>	<b>\$217.40</b>	<b>\$239.14</b>	<b>\$239.14</b>	<b>\$243.49</b>	<b>\$315.23</b>
<b>FFS36</b>	<b>36 x 2.5 x10</b>	<b>N/A</b>	<b>\$355.83</b>	<b>\$355.83</b>	<b>\$245.40</b>	<b>\$355.83</b>	<b>\$245.40</b>	<b>\$269.94</b>	<b>\$269.94</b>	<b>\$274.85</b>	<b>\$355.83</b>
<b>FFS42</b>	<b>42 x 2.5 x10</b>	<b>N/A</b>	<b>\$396.72</b>	<b>\$396.72</b>	<b>\$273.60</b>	<b>\$396.72</b>	<b>\$273.60</b>	<b>\$300.96</b>	<b>\$300.96</b>	<b>\$306.43</b>	<b>\$396.72</b>

## UNDER COUNTER KNEE DRAWERS



### SPECIFICATIONS:

- DRAWER UNIT DESIGNED TO BE INSTALLED UNDER COUNTER TO CREATE A DESK AREA.
- THESE DRAWERS WILL INSTALL BESIDE EITHER VANITY CABINETS (21" DEPTH) OR STANDARD BASE CABINETS (24" DEPTH).

ITEM	SIZES	ASP	HS	NG	PS	WPG	WS	MBS	FS	CS	RH
UCD30	30 x 7.5 x 21	232.76	\$223.29	\$221.68	\$221.68	\$221.68	\$221.68	\$243.85	\$243.85	\$248.28	\$223.29
UCD36	36 x 7.5 x 21	264.02	\$257.68	\$251.45	\$251.45	\$251.45	\$251.45	\$276.60	\$276.60	\$281.62	\$257.68



## APPLIANCE GARAGE

### SPECIFICATIONS:

- DESIGNED FOR INSTALLATION ON COUNTERTOP.
- FITS DIRECTLY BELOW A WALL DIAGONAL CORNER CABINET.
- THERE ARE NO SHELVES IN THIS CABINET.

ITEM	SIZES	ASP	HS	NG	PS	WPG	WS	MBS	FS	CS	RH
AG2418	24 x 18 x 24	\$391.69	\$373.04	\$373.04	\$373.04	\$373.04	\$373.04	\$410.34	\$410.34	\$417.80	\$373.04

## CORBELS

### SPECIFICATIONS:

- AVAILABLE IN 2 SIZE OPTIONS



ITEM	SIZES	ASP	HS	NG	PS	WPG	WS	MBS	FS	CS	RH
CBLPN2	small	\$215.19	\$203.33	\$203.33	\$203.33	\$203.33	\$203.33	\$223.66	\$223.66	\$227.73	\$203.33
CBLPN3	large	\$295.39	\$281.32	\$281.32	\$281.32	\$281.32	\$281.32	\$309.45	\$309.45	\$315.08	\$281.32

## PLATE RACK

### SPECIFICATIONS:

- WILL HOLD 10 PLATES.
- PLATE RACK MAY ALSO BE USED WITH WALL AND BASE CABINETS.



ITEM	SIZES	ASP	HS	NG	PS	WPG	WS	MBS	FS	CS	RH
PR3015	30 x 15 x 12	\$345.77	\$303.95	\$303.95	\$303.95	\$303.95	\$303.95	\$334.35	\$334.35	\$340.42	\$303.95

**TOILET TOPPER**

**SPECIFICATIONS:**



- BUTT DOORS ON TOP
- TILT OUT DRAWER ON BOTTOM
- OPENING BETWEEN DOORS AND TILT OUT DRAWER HAS A MATCHING FINISH
- OPENING IS 20 7/8" WIDE X 5 3/4" TALL

ITEM	SIZES	ASP	HS	NG	PS	WPG	WS	MBS	FS	CS	RH
TT2436	30 x 15 x 8	N/A	\$659.34	\$659.34	\$454.72	\$659.34	\$454.72	\$500.19	\$500.19	\$509.29	\$659.34

**RANGE HOOD FRONTS**

**SPECIFICATIONS:**



- MUST BE INSTALLED BETWEEN TWO CABINETS FOR SUPPORT.
- BEFORE INSTALLATION OF THE RHF OCCURS, THE BLOWER SHOULD BE INSTALLED AND THE DEPTH ADJUSTED USING FILLERS AND/OR PANELS TO FIT THE BLOWER.
- INSTALL BLOWER FIRST

ITEM	SIZES	ASP	HS	NG	PS	WPG	WS	MBS	FS	CS	RH
RHF30	30 x 23.5 x 8	\$404.22	\$384.97	\$384.97	\$384.97	\$384.97	\$384.97	\$423.47	\$423.47	\$431.17	\$384.97
RHF36	36 x 23.5 x 8	\$453.31	\$431.72	\$431.72	\$431.72	\$431.72	\$431.72	\$474.89	\$474.89	\$483.53	\$431.72

**REV-A-SHELF SINGLE AND DOUBLE TRASH CAN KIT**

**SPECIFICATIONS:**



- 4VLWCSC1835DM211-12:
- DOUBLE 35QT FRAME WITH SLIDES & TRASH CANS.
  - COMPATIBLE WITH ALL LINES AND DOOR MOUNTS TO THE FRONT OF THE SHELF.
  - SMALLEST CAB IT WILL FIT IN IS 18"

**SPECIFICATIONS:**

- 4VLWCSC1535DM111-18:
- SINGLE 35QT FRAME WITH SLIDES & TRASH CAN.
  - WILL FIT A 15" - 18" BASE CABINET.
  - COMPATIBLE WITH ALL LINES AND DOOR MOUNTS TO THE FRONT OF THE SHELF.

ITEM	UNIV
<b>4VLWCSC1535DM111-18</b>	<b>\$179.99</b>
<b>4VLWCSC1835DM211-12</b>	<b>\$199.99</b>

# SINGLE GLASS DOORS

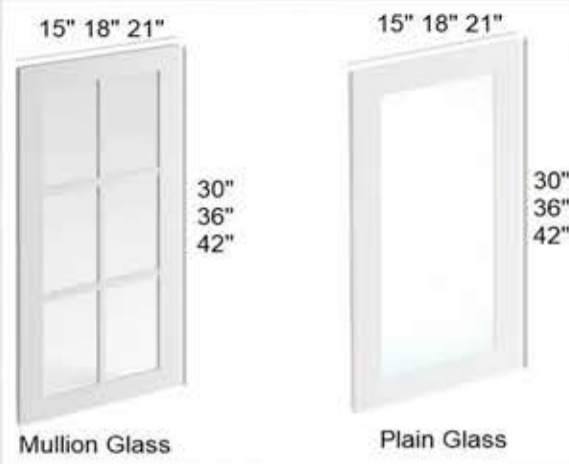

## SPECIFICATIONS:

- MATCH THE PROFILE OF THE SELECTED DOOR STYLE.
- THE INFORMATION FOLLOWING MD IN THE SKU INDICATE THE SIZE / TYPE OF CABINET THE DOOR WILL FIT. EX: MD2442 FITS A W2442. EX: MDWDC36 FITS A WDC2436.
- 30" AND 36" HIGH CABINETS WILL HAVE 6 PANES WHILE 42" HIGH CABINETS WILL HAVE 8.

ITEM	SIZES	ASP	HS	NG	PS	WPG	WS	MBS	FS	CS	RH
MD1530	15 x 30	N/A	N/A	N/A	\$87.60	N/A	\$87.60	\$96.36	\$96.36	\$98.11	N/A
MD1830	18 x 30	N/A	N/A	N/A	\$106.39	N/A	\$106.39	\$117.03	\$117.03	\$119.16	N/A
MD2130	21 x 30	N/A	N/A	N/A	\$177.24	N/A	\$177.24	\$194.96	\$194.96	\$198.51	N/A
MD1536	15 x 36	N/A	N/A	N/A	\$106.30	N/A	\$106.30	\$116.93	\$116.93	\$119.06	N/A
MD1836	18 x 36	N/A	N/A	N/A	\$126.88	N/A	\$126.88	\$139.57	\$139.57	\$142.11	N/A
MD2136	21 x 36	N/A	N/A	N/A	\$200.38	N/A	\$200.38	\$220.42	\$220.42	\$224.43	N/A
MD1542	15 x 42	N/A	N/A	N/A	\$121.21	N/A	\$121.21	\$133.33	\$133.33	\$135.76	N/A
MD1842	18 x 42	N/A	N/A	N/A	\$154.48	N/A	\$154.48	\$169.93	\$169.93	\$173.02	N/A
MD2142	21 x 42	N/A	N/A	N/A	\$238.35	N/A	\$238.35	\$262.19	\$262.19	\$266.95	N/A
ITEM	SIZES	ASP	HS	NG	PS	WPG	WS	MBS	FS	CS	RH
PG1530	15 x 30	N/A	\$141.50	\$141.50	\$87.60	\$141.50	\$87.60	\$96.36	\$96.36	\$98.11	\$141.50
PG1830	18 x 30	N/A	\$155.15	\$155.15	\$106.39	\$155.15	\$106.39	\$117.03	\$117.03	\$119.16	\$155.15
PG2130	21 x 30	N/A	\$177.24	\$177.24	\$177.24	\$177.24	\$177.24	\$194.96	\$194.96	\$198.51	\$177.24
PG1536	15 x 36	N/A	\$160.36	\$160.36	\$106.30	\$160.36	\$106.30	\$116.93	\$116.93	\$119.06	\$160.36
PG1836	18 x 36	N/A	\$177.28	\$177.28	\$126.88	\$177.28	\$126.88	\$139.57	\$139.57	\$142.11	\$177.28
PG2136	21 x 36	N/A	\$200.38	\$200.38	\$200.38	\$200.38	\$200.38	\$220.42	\$220.42	\$224.43	\$200.38
PG1542	15 x 42	N/A	\$171.65	\$171.65	\$121.21	\$171.65	\$121.21	\$133.33	\$133.33	\$135.76	\$171.65
PG1842	18 x 42	N/A	\$194.25	\$194.25	\$154.48	\$194.25	\$154.48	\$169.93	\$169.93	\$173.02	\$194.25
PG2142	21 x 42	N/A	\$238.35	\$238.35	\$238.35	\$238.35	\$238.35	\$262.19	\$262.19	\$266.95	\$238.35

# SET OF DOUBLE GLASS DOORS



## SPECIFICATIONS:

- MATCH THE PROFILE OF THE SELECTED DOOR STYLE.
- THE INFORMATION FOLLOWING MD IN THE SKU INDICATE THE SIZE / TYPE OF CABINET THE DOOR WILL FIT. EX: MD2442 FITS A W2442. EX: MDWDC36 FITS A WDC2436.
- 30" AND 36" HIGH CABINETS WILL HAVE 6 PANES WHILE 42" HIGH CABINETS WILL HAVE 8

ITEM	SIZES	ASP	HS	NG	PS	WPG	WS	MBS	FS	CS	RH
PG2430	24 x 30	N/A	\$199.75	\$199.75	\$173.46	\$199.75	\$173.46	\$190.81	\$190.81	\$194.28	\$199.75
PG3030	30 x 30	N/A	\$222.73	\$222.73	\$199.75	\$222.73	\$199.75	\$219.13	\$219.13	\$223.72	\$222.73
PG3630	36 x 30	N/A	\$237.80	\$237.80	\$208.03	\$237.80	\$208.03	\$228.83	\$228.83	\$232.99	\$237.80
PG2436	24 x 36	N/A	\$223.48	\$223.48	\$208.03	\$223.48	\$208.03	\$228.83	\$228.83	\$232.99	\$223.48
PG3036	30 x 36	N/A	\$245.32	\$245.32	\$223.48	\$245.32	\$223.48	\$245.83	\$245.83	\$250.30	\$245.32
PG3636	36 x 36	N/A	\$269.76	\$269.76	\$249.31	\$269.76	\$249.31	\$274.24	\$274.24	\$279.23	\$269.76
PG2442	24 x 42	N/A	\$282.45	\$282.45	\$242.26	\$282.45	\$242.26	\$266.49	\$266.49	\$271.33	\$282.45
PG3042	30 x 42	N/A	\$326.55	\$326.55	\$282.45	\$326.55	\$282.45	\$310.70	\$310.70	\$316.34	\$326.55
PG3642	36 x 42	N/A	\$341.63	\$341.63	\$291.27	\$341.63	\$291.27	\$320.40	\$320.40	\$326.22	\$341.63
ITEM	SIZES	ASP	HS	NG	PS	WPG	WS	MBS	FS	CS	RH
MD2430	24 x 30	N/A	N/A	N/A	\$173.46	N/A	\$173.46	\$190.81	\$190.81	\$194.28	N/A
MD3030	30 x 30	N/A	N/A	N/A	\$199.75	N/A	\$199.75	\$219.13	\$219.13	\$223.72	N/A
MD3630	36 x 30	N/A	N/A	N/A	\$208.03	N/A	\$208.03	\$228.83	\$228.83	\$232.99	N/A
MD2436	24 x 36	N/A	N/A	N/A	\$218.52	N/A	\$218.52	\$240.31	\$240.31	\$244.14	N/A
MD3036	30 x 36	N/A	N/A	N/A	\$223.48	N/A	\$223.48	\$245.83	\$245.83	\$250.30	N/A
MD3636	36 x 36	N/A	N/A	N/A	\$249.31	N/A	\$249.31	\$274.24	\$274.24	\$279.23	N/A
MD2442	24 x 42	N/A	N/A	N/A	\$242.26	N/A	\$242.26	\$266.49	\$266.49	\$271.33	N/A
MD3042	30 x 42	N/A	N/A	N/A	\$282.45	N/A	\$282.45	\$310.70	\$310.70	\$316.34	N/A
MD3642	36 x 42	N/A	N/A	N/A	\$291.27	N/A	\$291.27	\$320.40	\$320.40	\$326.22	N/A

**SINGLE GLASS DIAGONAL DOORS**

**SPECIFICATIONS:**

- MULLION GLASS
- PLAIN GLASS



ITEM	SIZES	ASP	HS	NG	PS	WPG	WS	MBS	FS	CS	RH
MDWDC30	15 x 30	N/A	N/A	N/A	\$137.42	N/A	\$137.42	\$151.16	\$151.16	\$153.91	N/A
MDWDC36	15 x 36	N/A	N/A	N/A	\$167.54	N/A	\$167.54	\$184.29	\$184.29	\$187.64	N/A
MDWDC42	15 x 42	N/A	N/A	N/A	\$192.70	N/A	\$192.70	\$211.97	\$211.97	\$215.82	N/A
PGWDC30	15 x 30	\$208.03	\$243.26	\$243.26	\$137.42	\$243.26	\$137.42	\$151.16	\$151.16	\$153.91	\$243.26
PGWDC36	15 x 36	\$249.31	\$287.57	\$287.57	\$167.54	\$465.42	\$167.54	\$184.29	\$184.29	\$187.64	\$287.57
PGWDC42	15 x 42	\$291.27	\$338.39	\$338.39	\$192.70	\$556.70	\$192.70	\$211.97	\$211.97	\$215.82	\$338.39

**TOUCH-UP KITS**

**SPECIFICATIONS:**

- INCLUDED IN KIT:
- ONE WAX PUTTY STICK
  - ONE TOUCH-UP MARKER



ITEM	SIZES	ASP	HS	NG	PS	WPG	WS	MBS	FS	CS	RH
TUK	N/A	\$83.96	\$79.96	\$79.96	\$79.96	\$79.96	\$79.96	\$87.96	\$87.96	\$89.56	\$79.96

# PANELS, FILLERS & TRIMS



### CROWN MOULDING

### SPECIFICATIONS:

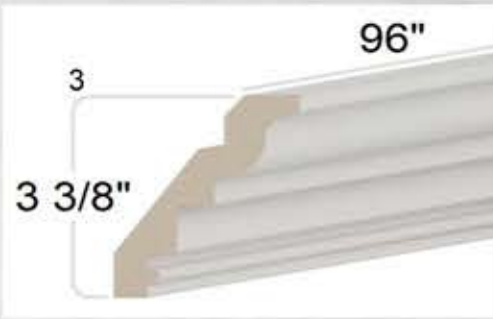

- SOLD IN 8 FT LONG SECTIONS.
- USE BEHIND LIGHT RAIL MOLDING WHEN WRAPPING AROUND THE SIDE OF A WALL CABINET.
- WHEN APPLYING CROWN TO FULL OVERLAY CABINETS, A CROWN BACKER WILL BE REQUIRED.

ITEM	SIZES	ASP	HS	NG	PS	WPG	WS	MBS	FS	CS	RH
LCM8	96 x 3-3/8 x 2.5	\$173.97	\$165.69	\$165.69	\$165.69	\$165.69	\$165.69	\$182.26	\$182.26	\$185.57	\$165.69

### LIGHT RAIL MOULDING

### SPECIFICATIONS:

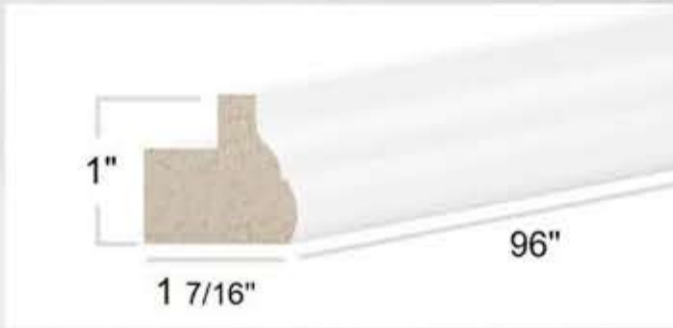

- SOLD IN 8FT. LONG SECTIONS

ITEM	SIZES	ASP	HS	NG	PS	WPG	WS	MBS	FS	CS	RH
LRM8	96 x 1-1/16 x 1	\$150.56	\$143.39	\$143.39	\$143.39	\$143.39	\$143.39	\$157.73	\$157.73	\$160.60	\$143.39

### SCRIBE MOULDING

### SPECIFICATIONS:



- SOLD IN 8 FT LONG SECTIONS.
- USE BEHIND LIGHT RAIL MOLDING WHEN WRAPPING AROUND THE SIDE OF A WALL CABINET.

ITEM	SIZES	ASP	HS	NG	PS	WPG	WS	MBS	FS	CS	RH
SM8	96 x 0.75 x 0.25	\$36.65	\$34.90	\$34.90	\$34.90	\$34.90	\$34.90	\$38.39	\$38.39	\$39.09	\$143.39

### COVE CROWN MOULDING

### SPECIFICATIONS:

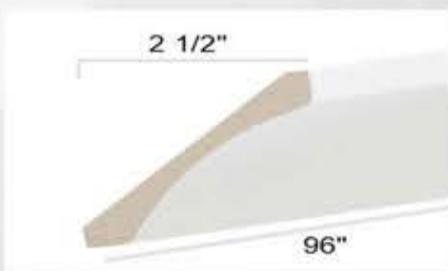

- SOLD IN 8 FT LONG SECTIONS.

ITEM	SIZES	ASP	HS	NG	PS	WPG	WS	MBS	FS	CS	RH
LVC	96 x 2-5/8 x 2.5	N/A	206.48	\$146.96	\$146.96	N/A	\$146.96	\$161.66	\$161.66	\$164.60	\$143.39



**BASE SKIN**

**SPECIFICATIONS:**

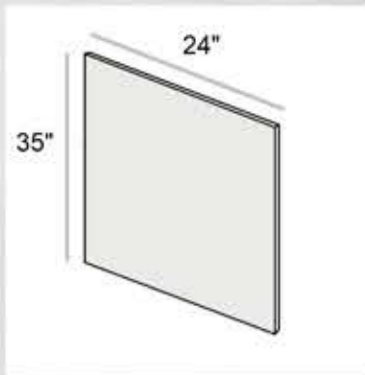

- 1/4" THICK PLYWOOD FINISHED TO MATCH
- FIELD TRIMMABLE

ITEM	SIZES	ASP	HS	NG	PS	WPG	WS	MBS	FS	CS	RH
<b>BS2435</b>	<b>24 x 35 x 0.25</b>	<b>N/A</b>	<b>\$130.99</b>	<b>\$125.99</b>	<b>N/A</b>	<b>N/A</b>	<b>N/A</b>	<b>N/A</b>	<b>N/A</b>	<b>N/A</b>	<b>\$130.99</b>

**DECORATIVE BASE MOULDING**

**SPECIFICATIONS:**

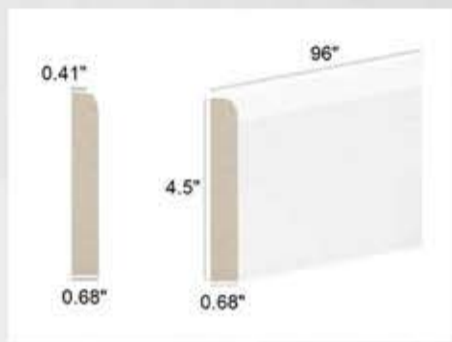

- SOLD IN 8 FT LONG SECTIONS.
- 4 1/2" INCHES TALL.
- 11/16 INCH THICK.

ITEM	SIZES	ASP	HS	NG	PS	WPG	WS	MBS	FS	CS	RH
<b>DEC004</b>	<b>96 x 4.5 x 11/16</b>	<b>\$70.35</b>	<b>\$70.35</b>	<b>\$70.35</b>	<b>\$70.35</b>	<b>\$70.35</b>	<b>\$70.35</b>	<b>\$77.39</b>	<b>\$77.39</b>	<b>\$78.79</b>	<b>\$70.35</b>

**BATTEN MOULDING**

**SPECIFICATIONS:**

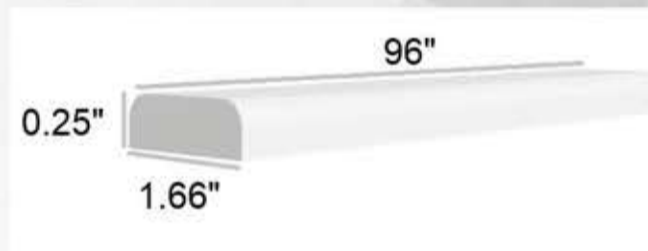

- 1/4" THICK PLYWOOD FINISHED TO MATCH
- FIELD TRIMMABLE

ITEM	SIZES	ASP	HS	NG	PS	WPG	WS	MBS	FS	CS	RH
<b>BM8</b>	<b>96 x 1.66 x 0.25</b>	<b>\$64.87</b>	<b>\$61.78</b>	<b>\$61.78</b>	<b>\$61.78</b>	<b>\$61.78</b>	<b>\$61.78</b>	<b>\$67.96</b>	<b>\$67.96</b>	<b>\$68.19</b>	<b>\$61.78</b>

**SPLIT CORNER DECORATIVE LEG**

**SPECIFICATIONS:**



- SOLD IN 42" LONG SECTIONS.

ITEM	SIZES	ASP	HS	NG	PS	WPG	WS	MBS	FS	CS	RH
<b>SCDL</b>	<b>3 x 42 x 3</b>	<b>\$207.69</b>	<b>\$207.69</b>	<b>\$207.69</b>	<b>\$243.95</b>	<b>\$207.69</b>	<b>\$243.95</b>	<b>\$268.35</b>	<b>\$268.35</b>	<b>\$273.22</b>	<b>\$207.69</b>

**MATCHING TALL END PANEL**

**SPECIFICATIONS:**

- ATTACHES TO SIDE OF TALL CABINET
- 3/4" THICK PLYWOOD FINISHED TO MATCH
- NOT TRIMMABLE
- COMES IN TWO PIECES



ITEM	SIZES	ASP	HS	NG	PS	WPG	WS	MBS	FS	CS	RH
<b>MTEP84</b>	<b>23.25 x 84</b>	<b>N/A</b>	<b>\$841.93</b>	<b>\$841.93</b>	<b>\$580.64</b>	<b>\$841.93</b>	<b>\$580.64</b>	<b>\$638.70</b>	<b>\$638.70</b>	<b>\$650.32</b>	<b>\$841.93</b>
<b>MTEP90</b>	<b>23.25 x 90</b>	<b>N/A</b>	<b>\$902.60</b>	<b>\$902.60</b>	<b>\$622.48</b>	<b>\$902.60</b>	<b>\$622.48</b>	<b>\$684.73</b>	<b>\$684.73</b>	<b>\$697.80</b>	<b>\$902.60</b>
<b>MTEP96</b>	<b>23.25 x 96</b>	<b>N/A</b>	<b>\$963.73</b>	<b>\$963.73</b>	<b>\$664.64</b>	<b>\$963.73</b>	<b>\$664.64</b>	<b>\$731.10</b>	<b>\$731.10</b>	<b>\$744.40</b>	<b>\$963.73</b>

**PLYWOOD EDGE BANDED**

**SPECIFICATIONS:**

- GRAIN RUNS WITH LONG SIDE
- FIELD TRIMMABLE

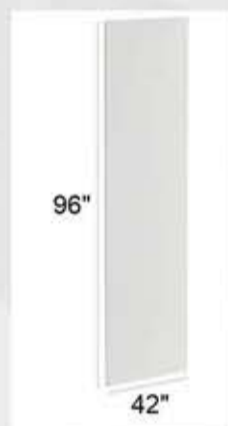

ITEM	SIZES	ASP	HS	NG	PS	WPG	WS	MBS	FS	CS	RH
<b>PLYEB42</b>	<b>42 x 96 x 0.75</b>	<b>N/A</b>	<b>\$422.96</b>	<b>\$422.96</b>	<b>\$422.96</b>	<b>\$422.96</b>	<b>\$422.96</b>	<b>\$465.26</b>	<b>\$465.26</b>	<b>\$473.72</b>	<b>\$422.96</b>

**BEAD BOARD**

**SPECIFICATIONS:**

- 3/8" THICK
- FIELD TRIMMABLE

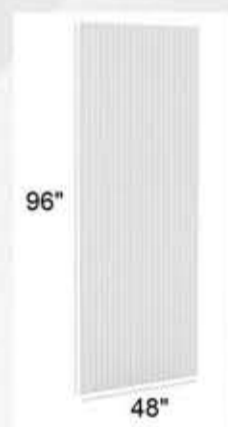

ITEM	SIZES	ASP	HS	NG	PS	WPG	WS	MBS	FS	CS	RH
<b>BBFBP4896</b>	<b>48 x 96 x 0.37</b>	<b>N/A</b>	<b>\$795.18</b>	<b>\$795.18</b>	<b>\$548.40</b>	<b>\$795.18</b>	<b>\$548.40</b>	<b>\$603.24</b>	<b>\$603.24</b>	<b>\$614.21</b>	<b>\$795.18</b>

**MATCHING VANITY END PANEL**

**SPECIFICATIONS:**

- ATTACHES TO SIDE OF VANITY BASE CABINET
- MATCHES STYLE AND COLOR OF CABINET DOORS

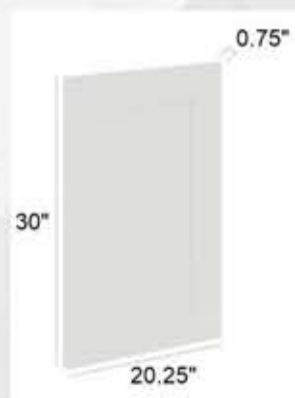

ITEM	SIZES	ASP	HS	NG	PS	WPG	WS	MBS	FS	CS	RH
<b>MVEPBH</b>	<b>20.25 x 30 x 0.75</b>	<b>N/A</b>	<b>\$189.37</b>	<b>\$198.99</b>	<b>\$189.37</b>	<b>\$198.99</b>	<b>\$189.37</b>	<b>\$208.31</b>	<b>\$208.31</b>	<b>\$212.09</b>	<b>\$189.37</b>

### WALL END PANEL

### SPECIFICATIONS:



- 1/2" THICK PANEL WITH A 3" WIDE WALL FILLER ON THE FRONT.
- CAN BE TRIMMED TO DESIRED HEIGHT AND/OR WIDTH.
- MAY BE USED EITHER LEFT OR RIGHT.

ITEM	SIZES	ASP	HS	NG	PS	WPG	WS	MBS	FS	CS	RH
WEP1542	3 x 42 x 15	\$169.74	\$161.66	\$161.66	\$161.66	\$161.66	\$161.66	\$177.83	\$177.83	\$181.06	\$161.66

### BASE END PANEL

### SPECIFICATIONS:



- 1/2" THICK PANEL WITH A 3" WIDE BASE FILLER ON THE FRONT.
- MAY BE USED EITHER LEFT OR RIGHT.

ITEM	SIZES	ASP	HS	NG	PS	WPG	WS	MBS	FS	CS	RH
BEP3	3 x 34.5 x 24	\$114.00	\$108.57	\$108.57	\$108.57	\$108.57	\$108.57	\$119.43	\$119.43	\$121.60	\$108.57

### REFRIGERATOR END PANEL

### SPECIFICATIONS:

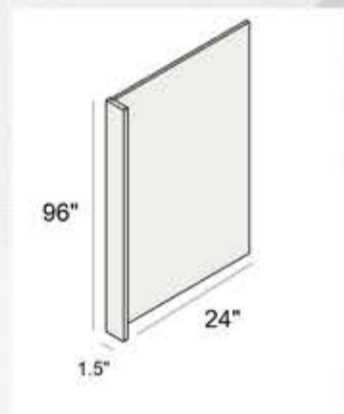

- 1/2" THICK PANEL WITH A 1 1/2" WIDE FILLER ON THE FRONT.
- CAN BE TRIMMED TO DESIRED HEIGHT AND/OR WIDTH.
- MAY BE USED EITHER LEFT OR RIGHT

ITEM	SIZES	ASP	HS	NG	PS	WPG	WS	MBS	FS	CS	RH
REP9624	1.5 x 96 x 24	\$235.27	\$224.07	\$224.07	\$224.07	\$224.07	\$224.07	\$246.48	\$246.48	\$250.96	\$224.07

### FLUTED WALL FILLERS

### SPECIFICATIONS:

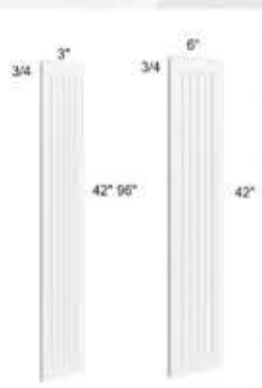

- 3/4" THICK.
- CAN BE TRIMMED TO DESIRED HEIGHT.
- 3" WIDE FILLERS HAVE 3 FLUTES.
- 6" WIDE FILLERS HAVE 5 FLUTES.
- FLUTES BEGIN 1.5" FROM THE TOP AND END 1.5" FROM THE BOTTOM.

ITEM	SIZES	ASP	HS	NG	PS	WPG	WS	MBS	FS	CS	RH
WFF342	3 x 42 x 0.75	\$79.22	\$75.45	\$75.45	\$75.45	\$75.45	\$75.45	\$83.00	\$83.00	\$84.50	\$75.45
WFF642	6 x 42 x 0.75	\$109.61	\$104.39	\$104.39	\$104.39	\$104.39	\$104.39	\$114.83	\$114.83	\$116.92	\$104.39
WFF396	3 x 96 x 0.75	\$174.28	\$165.98	\$165.98	\$165.98	\$165.98	\$165.98	\$182.58	\$182.58	\$185.90	\$165.98

## FLUTED BASE FILLERS



### SPECIFICATIONS:

- 3/4" THICK.
- CAN BE TRIMMED TO DESIRED HEIGHT.
- 3" WIDE FILLERS HAVE 3 FLUTES.
- 6" WIDE FILLERS HAVE 5 FLUTES.
- FLUTES BEGIN 1.5" FROM THE TOP AND END 1.5" FROM THE BOTTOM.
- THE TOE KICK AREA IS NOT FLUTED

ITEM	SIZES	ASP	HS	NG	PS	WPG	WS	MBS	FS	CS	RH
<b>BFF3</b>	<b>3 x 34.5 x 0.75</b>	\$53.66	\$51.10	\$51.10	\$51.10	\$51.10	\$51.10	\$56.21	\$56.21	\$57.23	\$51.10
<b>BFF6</b>	<b>6 x 34.5 x 0.75</b>	\$91.05	\$86.71	\$86.71	\$86.71	\$86.71	\$86.71	\$95.38	\$95.38	\$97.12	\$86.71
<b>TFF396</b>	<b>3 x 96 x 0.75</b>	\$181.17	\$172.54	\$172.54	\$172.54	\$172.54	\$172.54	\$189.79	\$189.79	\$193.24	\$172.54

## WALL FILLERS

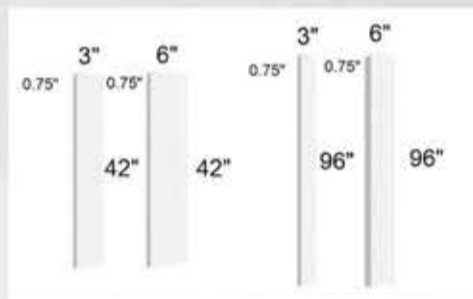

### SPECIFICATIONS:

- 3/4" THICK.
- CAN BE TRIMMED TO DESIRED HEIGHT AND/OR WIDTH

ITEM	SIZES	ASP	HS	NG	PS	WPG	WS	MBS	FS	CS	RH
<b>WF342</b>	<b>3 x 42 x 0.75</b>	\$42.56	\$40.53	\$40.53	\$40.53	\$40.53	\$40.53	\$44.58	\$44.58	\$45.39	\$40.53
<b>WF642</b>	<b>6 x 42 x 0.75</b>	\$81.19	\$77.32	\$77.32	\$77.32	\$77.32	\$77.32	\$85.05	\$85.05	\$86.60	\$77.32
<b>WF396</b>	<b>3 x 96 x 0.75</b>	\$160.83	\$153.17	\$153.17	\$153.17	\$153.17	\$153.17	\$168.49	\$168.49	\$171.55	\$153.17
<b>WF696</b>	<b>6 x 96 x 0.75</b>	N/A	\$398.24	\$398.24	\$398.24	\$398.24	\$398.24	\$438.06	\$398.24	\$398.24	\$398.24

## BASE FILLERS

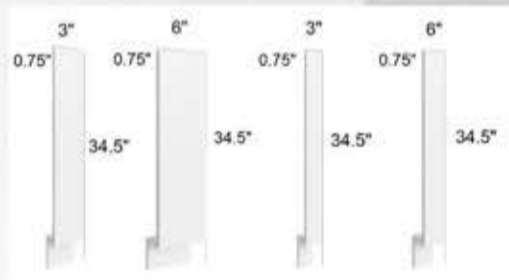

### SPECIFICATIONS:

- 3/4" THICK.
- CAN BE TRIMMED TO DESIRED HEIGHT AND/OR WIDTH

ITEM	SIZES	ASP	HS	NG	PS	WPG	WS	MBS	FS	CS	RH
<b>BF3</b>	<b>3 x 34.5 x 0.75</b>	\$34.66	\$33.01	\$33.01	\$33.01	\$33.01	\$33.01	\$36.31	\$36.31	\$36.97	\$33.01
<b>BF6</b>	<b>6 x 34.5 x 0.75</b>	\$69.59	\$66.28	\$66.28	\$66.28	\$66.28	\$66.28	\$72.91	\$72.91	\$74.23	\$66.28
<b>TF396</b>	<b>3 x 96 x 0.75</b>	\$160.83	\$153.17	\$153.17	\$153.17	\$153.17	\$153.17	\$168.49	\$168.49	\$171.55	\$153.17
<b>TF696</b>	<b>6 x 96 x 0.75</b>	\$398.24	\$398.24	\$398.24	\$398.24	N/A	\$398.24	\$438.06	\$438.06	\$446.03	\$398.24

## DECORATIVE END PANELS

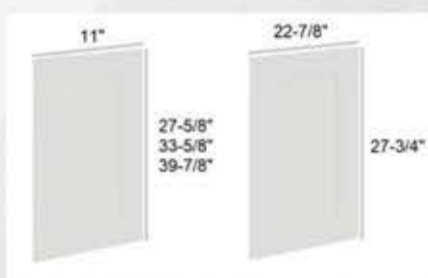

### SPECIFICATIONS:

- THESE THREE PANEL SIZES WILL RESEMBLE THE WALL CABINET DOORS.
- THE LAST TWO DIGITS IN THE ITEM NUMBER INDICATE THE HEIGHT OF WALL CABINET THESE PANELS WILL FIT. EX: DP1236 WILL FIT THE SIDE OF A W1236.

ITEM	SIZES	ASP	HS	NG	PS	WPG	WS	MBS	FS	CS	RH
<b>DP1230</b>	<b>12 x 30</b>	\$115.02	\$109.54	\$109.54	\$109.54	\$109.54	\$109.54	\$120.49	\$120.49	\$122.68	\$109.54
<b>DP1236</b>	<b>12 x 36</b>	\$131.16	\$124.91	\$124.91	\$124.91	\$124.91	\$124.91	\$137.40	\$137.40	\$139.90	\$124.91
<b>DP1242</b>	<b>12 x 42</b>	\$125.24	\$153.55	\$153.55	\$119.28	\$153.55	\$119.28	\$131.21	\$131.21	\$133.59	\$153.55
<b>DP2430</b>	<b>24 x 30</b>	\$178.69	\$179.76	\$179.76	\$170.18	\$179.76	\$170.18	\$187.20	\$187.20	\$190.60	\$179.76

**TOE KICK**

**SPECIFICATIONS:**



- 1/4" THICK.
- CAN BE CUT TO FIT.

ITEM	SIZES	ASP	HS	NG	PS	WPG	WS	MBS	FS	CS	RH
<b>TK8</b>	<b>96 x 0.25 x 4.5</b>	<b>\$67.87</b>	<b>\$64.64</b>	<b>\$64.64</b>	<b>\$64.64</b>	<b>\$64.64</b>	<b>\$64.64</b>	<b>\$71.10</b>	<b>\$71.10</b>	<b>\$72.40</b>	<b>\$64.64</b>

**OUTSIDE CORNER MOULDING**

**SPECIFICATIONS:**



- SOLD IN 8FT. LONG SECTIONS

ITEM	SIZES	ASP	HS	NG	PS	WPG	WS	MBS	FS	CS	RH
<b>OCS8</b>	<b>96 x 13/16 x 1/4</b>	<b>\$47.63</b>	<b>\$45.36</b>	<b>\$45.36</b>	<b>\$45.36</b>	<b>\$45.36</b>	<b>\$45.36</b>	<b>\$49.90</b>	<b>\$49.90</b>	<b>\$50.80</b>	<b>\$45.36</b>

**SHOE MOULDING**

**SPECIFICATIONS:**



- 3/4" TALL
- 1/2" THICK
- CAN BE TRIMMED TO DESIRED HEIGHT AND/OR WIDTH.

ITEM	SIZES	ASP	HS	NG	PS	WPG	WS	MBS	FS	CS	RH
<b>SHM8</b>	<b>96 x 0.75 x 0.25</b>	<b>\$36.65</b>	<b>\$34.90</b>	<b>\$34.90</b>	<b>\$34.90</b>	<b>\$34.90</b>	<b>\$34.90</b>	<b>\$38.39</b>	<b>\$38.39</b>	<b>\$39.09</b>	<b>\$34.90</b>

**ROPE INSERT MOULDING**

**SPECIFICATIONS:**



- SOLD IN 8 FT LONG SECTIONS.
- 9/16TH OF AN INCH WIDE.
- 1/4 INCH THICK.
- CROWN MOLDING INSERT.

ITEM	SIZES	ASP	HS	NG	PS	WPG	WS	MBS	FS	CS	RH
<b>ROPE8</b>	<b>96 x 9/16 x 0.25</b>	<b>\$69.10</b>	<b>\$65.81</b>	<b>\$65.81</b>	<b>\$65.81</b>	<b>\$65.81</b>	<b>\$65.81</b>	<b>\$72.39</b>	<b>\$72.39</b>	<b>\$73.71</b>	<b>\$65.81</b>

# SAMPLE DOORS

ITEM	SIZES	ASP	HS	NG	PS	WPG	WS	MBS	FS	CS	RH
DD	N/A	\$40.00	\$40.00	\$40.00	\$40.00	\$40.00	\$40.00	\$44.00	\$44.00	\$44.80	\$40.00

## DISPLAY/SAMPLE DOOR



ASP

HS

WPG



NG

PS

WS

RH



MBS

FS

CS

## COLOR KEY

Aspen White	= ASP	Winchester Grey	= NG	Hickory Shaker	= HS
West Point Grey	= WPG	White Shaker	= WS	Platinum Shaker	= PS
Fresh Sage	= FS	Carmel Shaker	= CS	Midnight Black Shaker	= MBS
Rustic Hickory	= RH				

